

# BROWN JORDAN

## OUTDOOR KITCHENS



## STAINLESS STEEL CABINETRY

## SPECIFICATIONS

Brown Jordan Outdoor Kitchens feature #4 brushed stainless doors, drawer fronts and cabinet interiors. Unique door styles powder coat options are also available to provide a rich contemporary look. The modular cabinetry provides designers and home owners with infinite flexibility in design configurations. Kitchens may be designed in concert with stucco or stone to complement the landscape architecture of the outdoors.

Brown Jordan Outdoor Kitchens stainless kitchen cabinetry is warranted to hold up for years under the most severe weather conditions... or demanding chefs.

European frameless design full overlay cabinets are fabricated with commercial grade 20-gauge stainless steel and are available in 24" and 27" depths for both indoor and outdoor applications. A quick look inside reveals the craftsmanship as the interior is void of any hardware and screw heads. Cabinet features include concealed stainless door hinges, solid core doors, trash pullouts, fixed and sliding shelves, leveling legs and "soft close, self close" drawers.

Brown Jordan Outdoor Kitchens offers the widest range of storage and organizational cabinetry in the industry. Cabinets are available in 3" increments (width) starting at 9" to as large as 48" in certain styles. Grill and appliance base cabinets are designed to accommodate every major manufacturer's grill.

The "easy-alignment" design system allows for quick, precise installation with less labor than typical wood cabinetry. Each cabinet stands alone and has quick connect features. Access holes in key locations for plumbing and electrical installation reduces the need for drilling, cutting and boring. A screw gun, long screwdriver, tape measure, level and the easy-to-follow instructions will ensure a professional installation the very first time.

Brown Jordan Outdoor Kitchens stainless kitchen cabinetry is warranted to hold up for years under the most severe weather conditions or demanding chefs.

## CABINET OVERVIEW

Base cabinetry is available in 3" increments, from 9" to 36" widths. Sink base and full height cabinets extend to 48". 24" wide cabinets can be specified with one or two doors.

While the standard outdoor cabinet depth is 27<sup>7</sup>/<sub>8</sub>" (including door), a 24<sup>7</sup>/<sub>8</sub>" depth may be specified. Total height is 34<sup>1</sup>/<sub>2</sub>". The cabinet box is 30"H plus 4<sup>1</sup>/<sub>2</sub>" adjustable legs. A square shaped tapered stainless steel leg with adjustable foot is also available for an open contemporary look. Black Anodized or stainless toe kick may be ordered separately and cut on-site. Stainless pulls, hinges and screws are included.

Drawers display premium features including #4 brush interior, double-wall construction, full extension, under-mount glides and "soft-close, self close". Doors have a PVC core to add "heft" and weight to provide a solid close and feel. Shelves are optional – fixed or pull out.

Wall cabinetry is available in 3" increments from 12" to 36". Standard heights also start at 15" and go to 42". Inside depth is the standard 12". The outside depth is 13" (13<sup>7</sup>/<sub>8</sub>" including door). Two doors are furnished with cabinets 24" to 36" in width. The line also includes diagonal corner and blind corner wall cabinets. Every cabinet is supplied with finished top and bottom panels, stainless pulls, stainless hinges and hardware. Wall cabinetry may also be fitted with standard or stainless legs and used as shallow depth base cabinets. Shelves are included.

Finished side panels are optional and are available in two configurations: flush to the cabinet side and as a 3/4" thick panel flush to the face of the door. Doors may be ordered in different styles and open for glass (OFG).

For "low maintenance" in harsh weather conditions, a clear powder coat "Protect A Coat" finish may be factory applied to safeguard the metal from chlorine (salt air). Brown Jordan Outdoor Kitchens also features a palette of designer colors and extremely realistic wood grain powder coats. All of the powder coats protect the stainless from chlorine (salt air) and muriatic acid which is used to clean pavers.

## OBF - FULL HEIGHT DOOR CABINETS

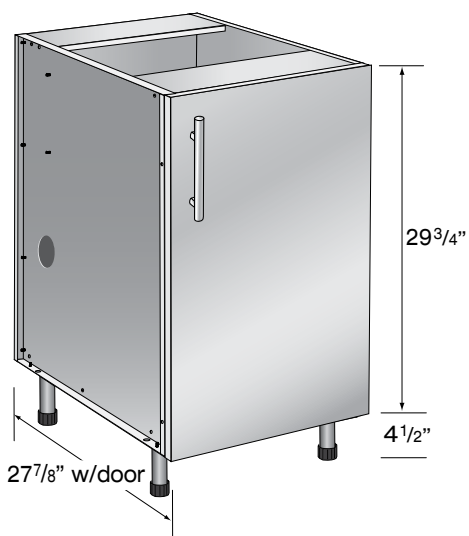

Example: Base Cabinet part number nomenclature;

OBF1801: 18" Full Height Door Cabinet

OB F 18 0 1  
Base Style Width Drawers Doors

All base cabinets standard depth is 27". For 24" depth cabinets, specify -24 after item #. For example OBF1501-24. Specify right or left hinge on single door sizes.

### ITEM #

OBF0901
OBF1201
OBF1501
OBF1801
OBF2101
OBF2401
OBF2402 (2D)
OBF2702 (2D)
OBF3002 (2D)
OBF3302 (2D)
OBF3602 (2D)
OBF3902 (2D)
OBF4202 (2D)
OBF4502 (2D)
OBF4802 (2D)

## OBD - 1 DRAWER, 1 (2) DOOR CABINETS

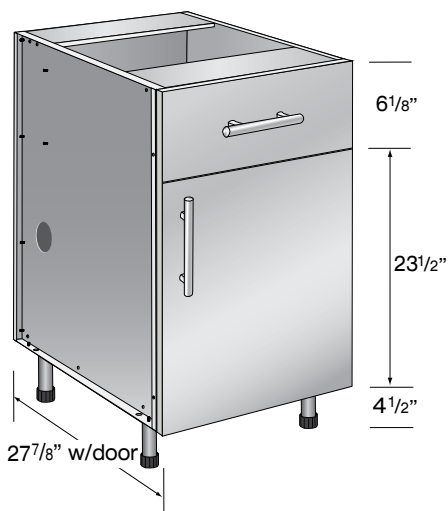

Example: Base Cabinet part number nomenclature;

OBD1811: 18" Door/Drawer Cabinet

OB D 18 1 1  
Base Style Width Drawers Doors

All base cabinets standard depth is 27". For 24" depth cabinets, specify -24 after item #. For example OBD1511-24. Specify right or left hinge on single door sizes.

### ITEM #

OBD0911
OBD1211
OBD1511
OBD1811
OBD2111
OBD2411
OBD2412 (2D)
OBD2712 (2D)
OBD3012 (2D)
OBD3312 (2D)
OBD3612 (2D)
OBD3912 (2D)

## OBM - 3 DRAWER CABINETS

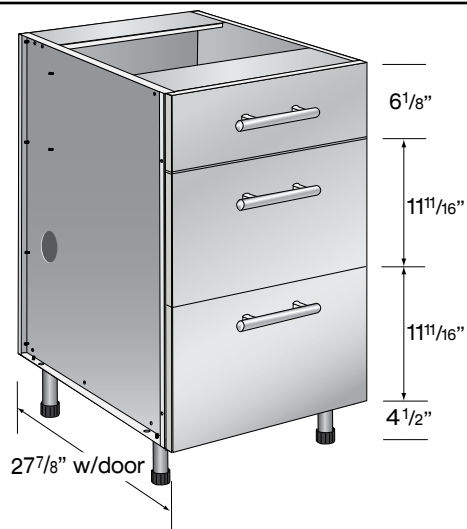

Example: Base Cabinet part number nomenclature;

OBM1830: 18" Multi-Drawer Cabinet

OB M 18 3 0  
Base Style Width Drawers Doors

All base cabinets standard depth is 27". For 24" depth cabinets, specify -24 after item #. For example OBM1530-24.

### ITEM #

OBM0930
OBM1230
OBM1530
OBM1830
OBM2130
OBM2430
OBM2730
OBM3030
OBM3330
OBM3630

## OBS - SINK BASE CABINETS

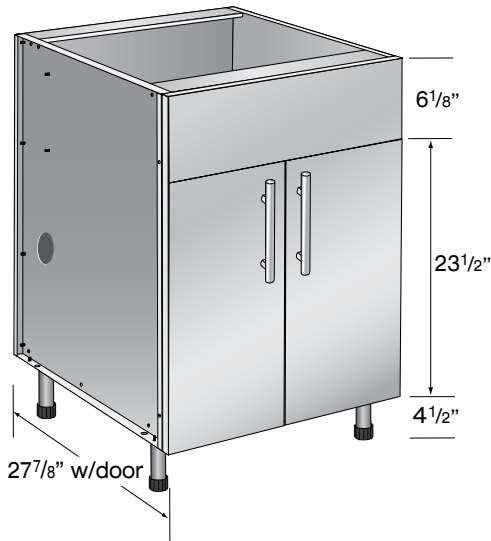

Example: Sink Base Cabinet part number nomenclature;

OBS3002: 30" Sink Base Cabinet

OB S 30 0 2  
Base Style Width Drawers Doors

All base cabinets standard depth is 27". For 24" depth cabinets, specify -24 after item #. For example OBS2401-24. Specify right or left hinge on single door sizes.

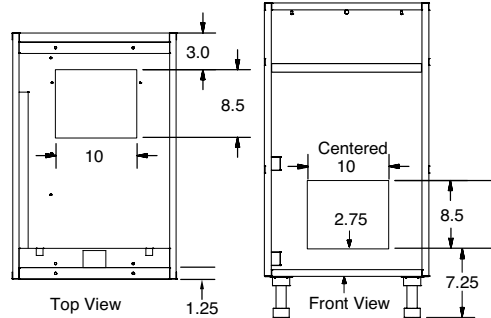

All OBS Sink Base Cabinets have precut openings in the back and bottom panels as well as the standard side openings for plumbing and electrical conduit

### ITEM #

OBS1501
OBS1801
OBS2101
OBS2401
OBS2402 (2D)
OBS2702 (2D)
OBS3002 (2D)
OBS3302 (2D)
OBS3602 (2D)
OBS3902 (2D)
OBS4202 (2D)
OBS4502 (2D)
OBS4802 (2D)

## OBTXX10 – Drawer & Door Trash Pull-Out Base Cabinet

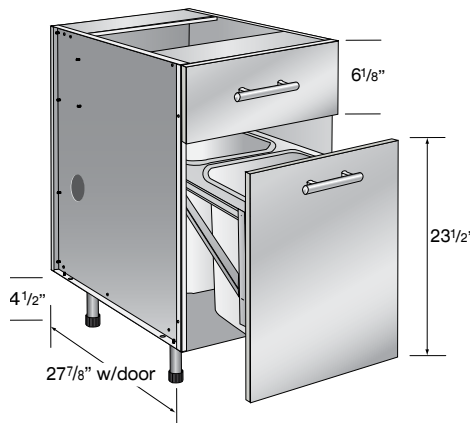

Example: Base Cabinet part number nomenclature;

OBT1800: 18" Full Height Door Cabinet

OB I 18 0 0  
Base Style Width Drawers Doors

All trash cabinet standard depths are 27". For 24" depth cabinets, specify -24 after item #. For example OBT1510-24. Trash cabinets can also be inserted into 36", 42" & 48" grill and 15"- 24" side burner cabinets (OTPXX trash pullout Accessory). The 15" cabinet has 1 trash basket, the 18", 21" and 24" contain 2 trash baskets.

### ITEM #

OBT1510
OBT1810
OBT2110
OBT2410

## OBTXX00 – Full Height Door Trash Pull-Out Base Cabinet

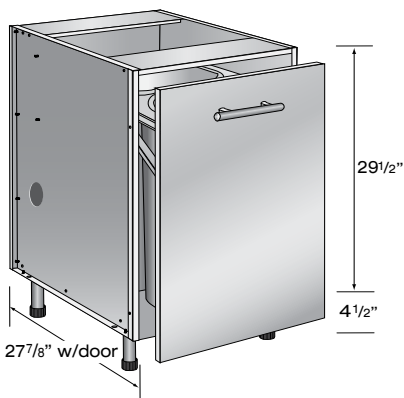

Example: Base Cabinet part number nomenclature;

OBT1800: 18" Full Height Door Cabinet

OB I 18 0 0  
Base Style Width Drawers Doors

All trash cabinet standard depths are 27". For 24" depth cabinets, specify -24 after item #. For example OBT1510-24. Trash cabinets can also be inserted into 36", 42" & 48" grill and 15"- 24" side burner cabinets (OTPXX trash pullout Accessory). The 15" cabinet has 1 trash basket, the 18", 21" and 24" contain 2 trash baskets.

### ITEM #

OBT1500
OBT1800
OBT2100
OBT2400



## GRILL BASE CABINETS

# BROWN JORDAN

## OUTDOOR KITCHENS

Grill base cabinets are available in widths from 33" to 62". Always specify the grill base cabinets 6" wider than the grill. A "trim kit" is installed during fabrication that is specifically designed for each grill. The trim kit tucks-in behind the control panel of the grill to ensure a proper fit. All grill base cabinets standard depth is 27".

Example: Base Cabinet part number nomenclature;

OGB3602: 36" Grill Base Cabinet w/2 doors for 30" wide grill

OG Appliance Type      B Style      36 Width      0 Drawers      2 Doors

### OGBXX02 — Door Only

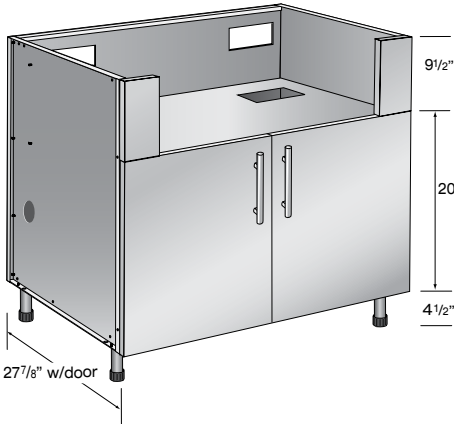

Always specify the grill base cabinets 6" wider than the grill. A "trim kit" is installed during fabrication that is specifically designed for each grill. The trim kit tucks-in behind the control panel of the grill to ensure a proper fit. Optional pull out and stationary shelves are available.

Most grills including Solaire and Alfresco call for standard cabinetry. Some grills have extra deep (top to bottom) burner boxes. When specifying cabinetry for Fire Magic, Twin Eagle and Wolf grills, place the letter "D" following the item number to indicate extra deep.

See page 8 for standard electrical, gas and plumbing cut-outs.

ITEM #
OGB3302
OGB3302D
OGB3602
OGB3602D
OGB4202
OGB4202D
OGB4802
OGB4802D

### OGBXX21 — Door/Drawer

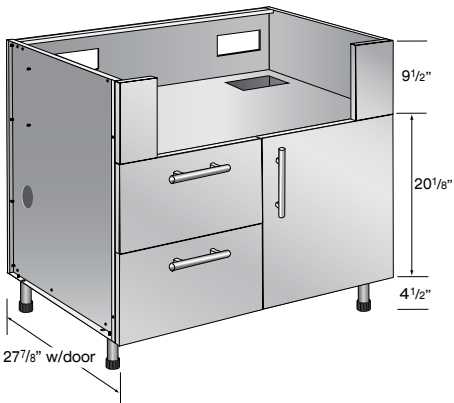

Always specify the grill base cabinets 6" wider than the grill. A "trim kit" is installed during fabrication that is specifically designed for each grill. The trim kit tucks-in behind the control panel of the grill to ensure a proper fit. Optional pull out and stationary shelves are available.

Most grills including Solaire and Alfresco call for standard cabinetry. Some grills have extra deep (top to bottom) burner boxes. When specifying cabinetry for Fire Magic, Twin Eagle and Wolf grills, place the letter "D" following the item number to indicate extra deep.

\*Extra depth cabinets not available in all sizes. Please contact us with your special needs.

See page 8 for standard electrical, gas and plumbing cut-outs.

ITEM #
OGB3321
OGB3621
OGB3621D
OGB4221
OGB4221D
OGB4821
OGB4821D

### OGBXX40 — Drawer Only

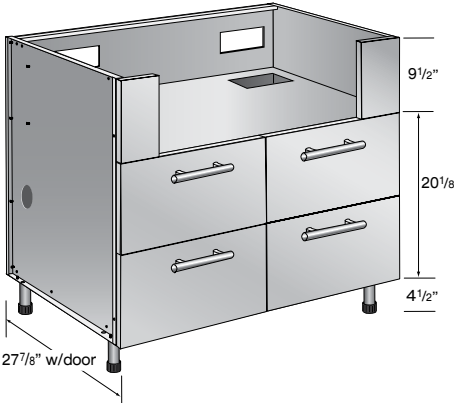

Always specify the grill base cabinets 6" wider than the grill. A "trim kit" is installed during fabrication that is specifically designed for each grill. The trim kit tucks-in behind the control panel of the grill to ensure a proper fit.

Most grills including Solaire and Alfresco call for standard cabinetry. Some grills have extra deep (top to bottom) burner boxes. When specifying cabinetry for Fire Magic, Twin Eagle and Wolf grills, place the letter "D" following the item number to indicate extra deep.

See page 8 for standard electrical, gas and plumbing cut-outs.

ITEM #
OGB3640
OGB4240
OGB4840

BASE CABINETS

## OGBXX03 — Door Only

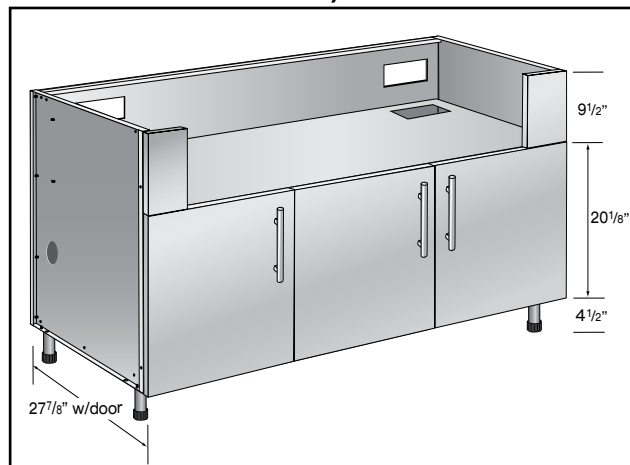

Always specify the grill base cabinets 6" wider than the grill. A "trim kit" is installed during fabrication that is specifically designed for each grill. The trim kit tucks-in behind the control panel of the grill to ensure a proper fit. Optional pull out and stationary shelves are available.

Most grills including Solaire and Alfresco call for standard cabinetry. Some grills have extra deep (top to bottom) burner boxes. When specifying cabinetry for Fire Magic, Twin Eagle and Wolf grills, place the letter "D" following the item number to indicate extra deep.

\*Extra depth cabinets not available in all sizes. Please contact us with your special needs.

See page 8 for standard electrical, gas and plumbing cut-outs.

ITEM #
OGB5403
OGB5803
OGB5803D
OGB6203

## OGBXX22 — 2 Drawer/2 Door

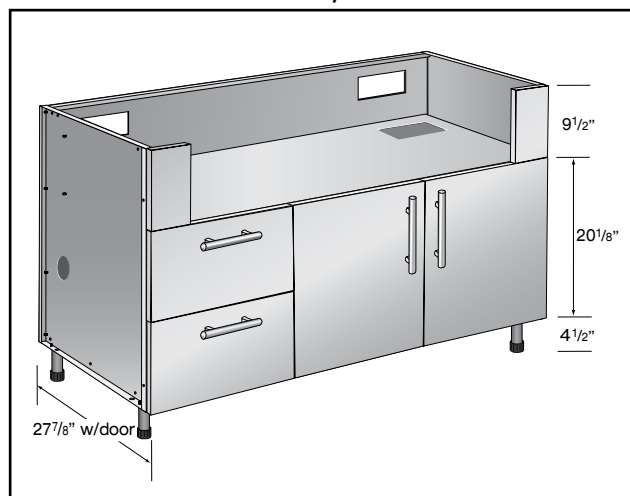

Always specify the grill base cabinets 6" wider than the grill. A "trim kit" is installed during fabrication that is specifically designed for each grill. The trim kit tucks-in behind the control panel of the grill to ensure a proper fit. Optional pull out and stationary shelves are available.

Most grills including Solaire and Alfresco call for standard cabinetry. Some grills have extra deep (top to bottom) burner boxes. When specifying cabinetry for Fire Magic, Twin Eagle and Wolf grills, place the letter "D" following the item number to indicate extra deep.

\*Extra depth cabinets not available in all sizes. Please contact us with your special needs.

See page 8 for standard electrical, gas and plumbing cut-outs.

ITEM #
OGB5422
OGB5822
OGB5822D
OGB6222

## OGBXX41 — 4 Drawer/1 Door

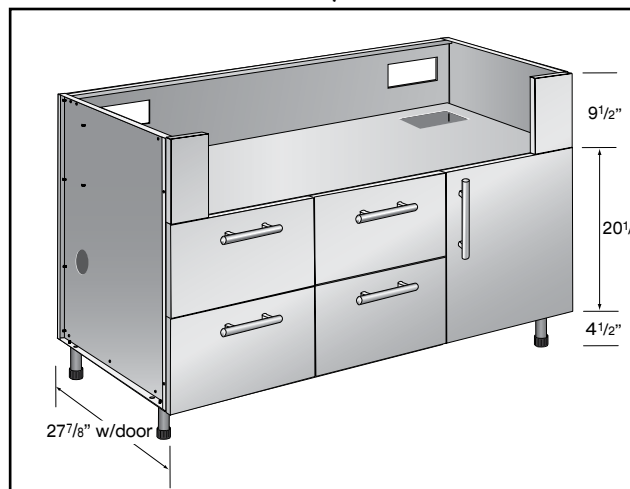

Always specify the grill base cabinets 6" wider than the grill. A "trim kit" is installed during fabrication that is specifically designed for each grill. The trim kit tucks-in behind the control panel of the grill to ensure a proper fit. Optional pull out and stationary shelves are available.

See page 8 for standard electrical, gas and plumbing cut-outs.

ITEM #
OGB5441
OGB5841
OGB6241

## OGWXX20 – Grill Base with Warming Drawer Insert

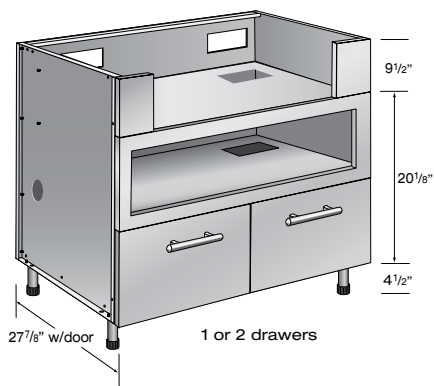

Always specify the grill base cabinets 6" wider than the grill. A "trim kit" is installed during fabrication that is specifically designed for each grill. The trim kit tucks-in behind the control panel of the grill to ensure a proper fit. Most grills including Solaire and Alfresco call for standard cabinetry. Some grills have extra deep (top to bottom) burner boxes. When specifying cabinetry for Fire Magic, Twin Eagle and Wolf grills, place the letter "D" following the item number to indicate extra deep.

ITEM #	ITEM #
OGW3610	OGW5420
OGW3600	OGW5411
OGW3600D	OGW5821
OGW4220	OGW5830
OGW4820	OGW6221
OGW4820D	
OGW4800	
OGW4800D	

\*Extra depth cabinets not available in all sizes. Please contact us with your special needs.

## OGFXX00 – Grill Base with Marinating Refrigerator Insert

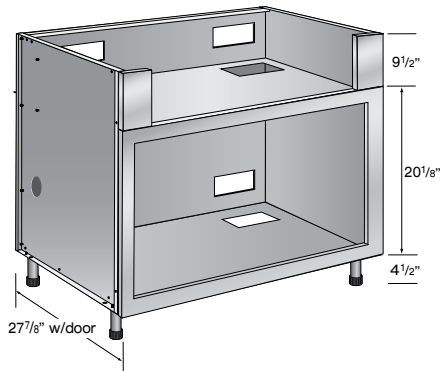

Always specify the grill base cabinets 6" wider than the grill. A "trim kit" is installed during fabrication that is specifically designed for each grill. The trim kit tucks-in behind the control panel of the grill to ensure a proper fit.

Most grills including Solaire and Alfresco call for standard cabinetry. Some grills have extra deep (top to bottom) burner boxes. When specifying cabinetry for Fire Magic, Twin Eagle and Wolf grills, place the letter "D" following the item number to indicate extra deep.

ITEM #
OGF4800
OGF6200

Grill cabinetry has been designed to accommodate all electrical, plumbing and gas necessities. There are cut-outs in the bottom, side, back panels as well as in the platform shelf that holds the grill or appliance. Below is a sampling of the appropriate cut-outs.

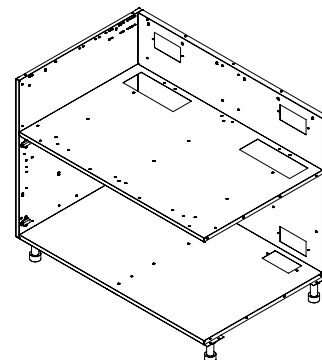
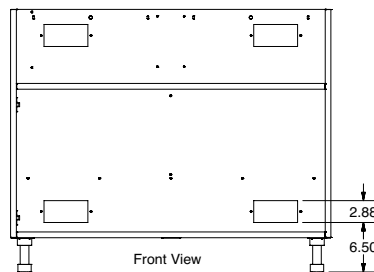
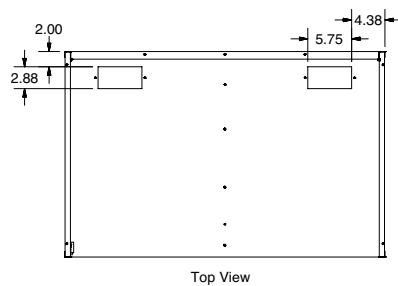

Appliance base cabinets are available in widths from 18" to 36", Bartending Centers from 24" to 48". Always specify the appliance base cabinets 6" wider than the appliance. A "trim kit" is installed during fabrication that is specifically designed for each appliance. The trim kit tucks-in behind the control panel of the appliance to ensure a proper fit. All appliance base cabinets standard depth is 27".

Example: Base Cabinet part number nomenclature;

OBB2702: 27" Appliance Base Cabinet w/2 doors for 21" wide appliance

OB      B      27      0      2  
Appliance Type    Style    Width    Drawers    Doors

## OBB — BURNER BASE CABINETS

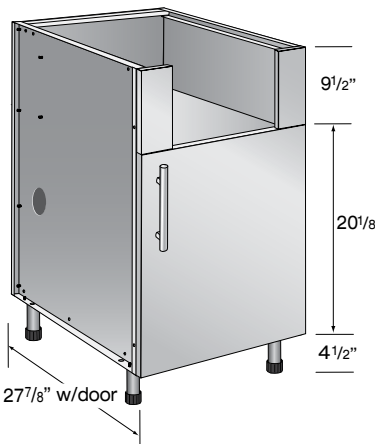

Always specify the appliance base cabinets 6" wider than the grill. A "trim kit" is installed during fabrication that is specifically designed for each grill. The trim kit tucks-in behind the control panel of the appliance to ensure a proper fit. Optional pull out and stationary shelves are available.

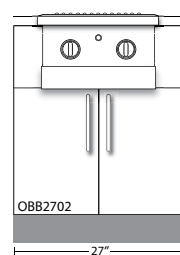

Most appliances including Solaire and Alfresco call for standard cabinetry. Some appliances have extra deep (top to bottom) burner boxes. When specifying cabinetry for Fire Magic, Twin Eagle and Wolf side burners, place the letter "D" following the item number to indicate extra deep.

\*Extra depth cabinets not available in all sizes. Please contact us with your special needs. See page 12 for standard electrical, gas and plumbing cutouts.

ITEM #
OBB1801
OBB1801D
OBB2101
OBB2101D
OBB2402
OBB2402D
OBB2702
OBB2702D

## OBB — HIGH INTENSITY BURNER BASE CABINETS

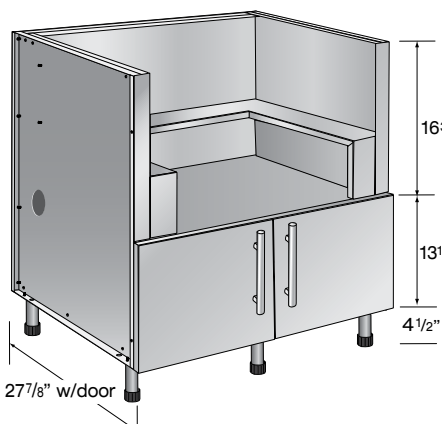

Always specify the appliance base cabinets 6" wider

There are two cabinet styles — one placing the burner at countertop level and the recessed cabinet (-Low) placing the burner 7" below the countertop. The more popular recessed cabinet offers more convenience for stock pot cooking.

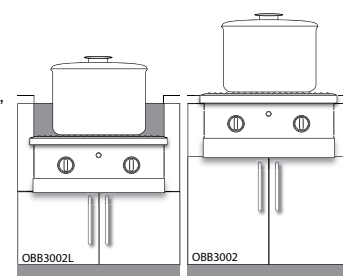

ITEM #
OBB2402-Low
OBB2702-Low
OBB3002
OBB3002-Low

## OEB — EGG SMOKER GRILL BASE CABINETS

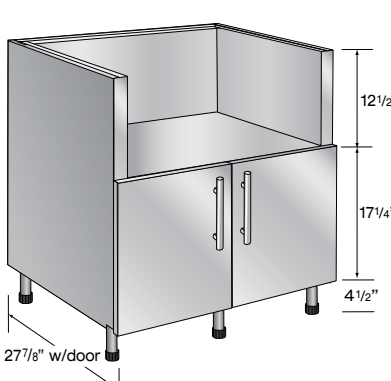

OEG Cabinets have additional support for the weight of the smoker grill eggs (up to & over 200 lbs.).

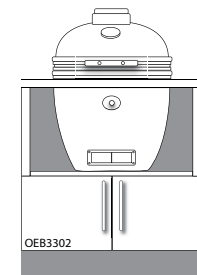

ITEM #
OEB2702 H22
OEB3302 H22



## OPB — PIZZA OVEN BASE CABINETS

27<sup>7</sup>/<sub>8</sub>" w/door

9<sup>1</sup>/<sub>2</sub>"

20<sup>1</sup>/<sub>8</sub>"

4<sup>1</sup>/<sub>2</sub>"

30"

The OPB Cabinet has additional support for the weight of the ovens (up to & over 400 lbs.).

OPB3002

30"

ITEM #
OPB3002

See page 12 for standard electrical, gas and plumbing cutouts.

## OBC/OGC — BARTENDER/COCKTAIL STATION BASE CABINETS

27<sup>7</sup>/<sub>8</sub>" w/door

9<sup>1</sup>/<sub>2</sub>"

20<sup>1</sup>/<sub>8</sub>"

4<sup>1</sup>/<sub>2</sub>"

48"

Always specify the appliance base cabinets 6" wider than the appliance. A "trim kit" is installed during fabrication that is specifically designed for each appliance. The trim kit tucks-in behind the control panel of the appliance to ensure a proper fit.

OGC4802 w/GLASTENDERHOME COCKTAIL STATION

48"

OBC3602

36"

ITEM #
OBC2402
OBC3002
OBC3302
OBC3602
OGC3602
OGC4802

See page 12 for standard electrical, gas and plumbing cutouts.

## OBMW — MICROWAVE OVEN BASE CABINETS

24<sup>7</sup>/<sub>8</sub>" w/door

17<sup>15</sup>/<sub>16</sub>"

11<sup>11</sup>/<sub>16</sub>"

4<sup>1</sup>/<sub>2</sub>"

30"

Always specify the appliance base cabinets 6" wider than the appliance.

OBMW3002

30"

ITEM #
OBMW3000-24
OBMW3002-24
OBMW3010-24

OBWXXXX – Warming Drawer Base

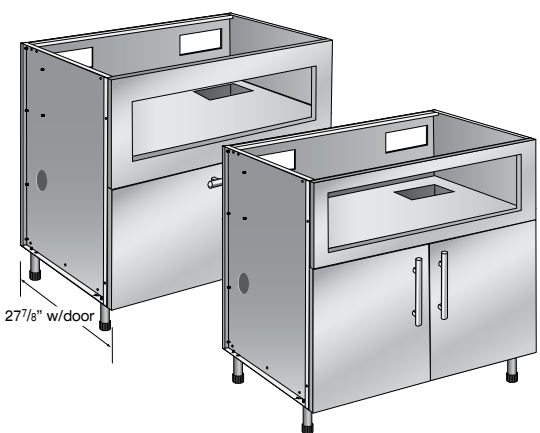

27 7/8" w/door

All warming drawer base cabinets standard depth is 27".  
The OBW3002 is made for 27" wide warming drawers. The OBW33xx's for 30". The OBW36xx's for 33" wide warming drawers.

ITEM #
OBW3002
OBW3302
OBW3310
OBW3602
OBW3610

OWDXX00 – Double Warming Drawer Base

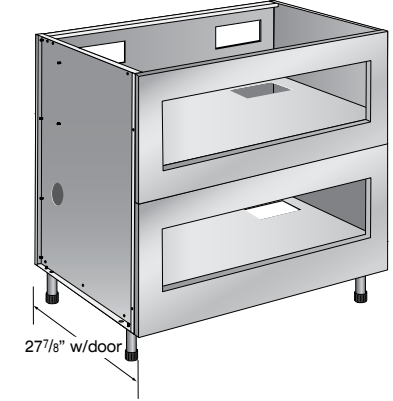

27 7/8" w/door

All warming drawer base cabinets standard depth is 27".  
The OWD3000 is made for 27" wide warming drawers. The OWD3300 for 30".

ITEM #
OWD3000
OWD3300

OBB & OBC Appliance cabinetry has been designed to accommodate all electrical, plumbing and gas necessities. There are cut-outs in the bottom, side, back panels as well as in the platform shelf that holds the grill or appliance. Below is a sampling of the appropriate cut-outs.

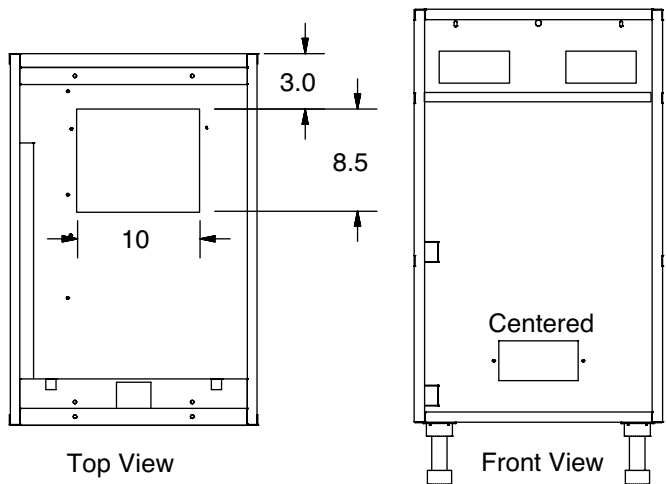

# VIKING GRILL & APPLIANCE BASE CABINETS **BROWN JORDAN** OUTDOOR KITCHENS

A full line of 29"D cabinetry is available to accommodate Viking grills and appliances that require extra depth (front to back). Always specify the grill base cabinets 6" wider than the grill or appliance. A "trim kit" is installed during fabrication that is specifically designed for each grill or appliance. The trim kit tucks-in behind the control panel to ensure a proper fit.

Example: Base Cabinet part number nomenclature;

VGB3602: 36" Grill Base Cabinet w/2 doors for 30" wide grill

VG                      B                      36                      0                      2  
Appliance Type      Style                      Width                      Drawers                      Doors

## VG SERIES – Viking Extra Depth (front to back) Grill & Oven Bases

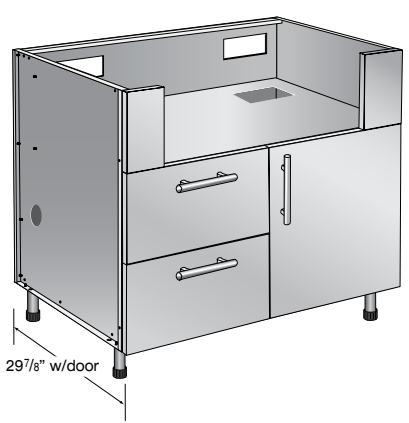

Always specify the grill base cabinets 6" wider than the grill. A "trim kit" is installed during fabrication that is specifically designed for each appliance. The trim kit tucks-in behind the control panel of the grill to ensure a proper fit.

ITEM #
VGB3602
VGB3621
VGW3610
VGB4802
VGB4821
VGW4820
VGB5803
VGB5822
VGW5821

## VG SERIES – Viking Extra Depth (front to back) Appliance Bases

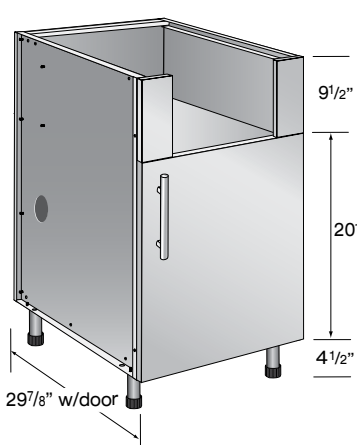

Always specify the appliance base cabinets 6" wider than the appliance. A "trim kit" is installed during fabrication that is specifically designed for each appliance. The trim kit tucks-in behind the control panel of the appliance to ensure a proper fit.

ITEM #
VBB1801
VBB2101
VBB3002
VBB3002-Low
VBC3002
VBW3002
VBW3010

BASE CABINETS

DCB — CORNER BASE CABINETS

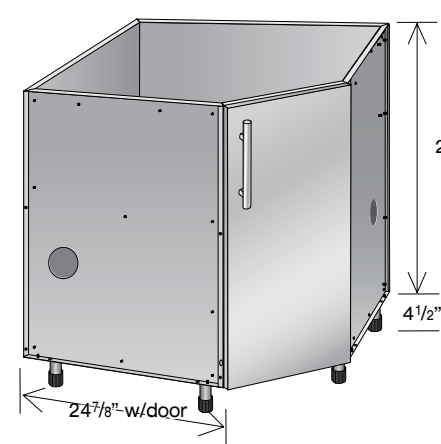

Example: Corner Base Cabinet part number nomenclature;  
DCB39: Corner cabinet for 27" deep cabinet run.

<u>DC</u>	<u>B</u>	<u>39</u>	<u>0</u>	<u>1</u>
Base	Style	Width	Drawers	Doors

All base cabinets standard depth is 27". For 24" depth cabinets, specify -24 after item #. For example DCB36 is the back panel size for the 24" depth cabinet run. Specify right or left hinge on single door sizes.

ITEM #
DCB39
DCB36

AEB — CORNER BASE CABINETS

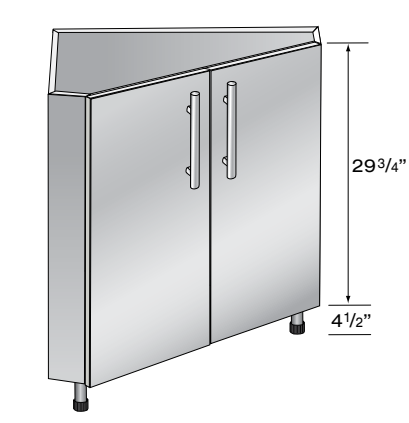

Example: AEB Corner Base Cabinet part number nomenclature;  
AEB2702: Corner cabinet for 27" deep cabinet run.

<u>AE</u>	<u>B</u>	<u>27</u>	<u>0</u>	<u>2</u>
Base	Style	Width	Drawers	Doors

ITEM #
AEB2702
AEB2402

Tall Specialty Cabinetry has been designed to accommodate all types of ovens as well as provide floor to ceiling storage. They can be used as a cleaning closet, a pantry or for most any use. Standard cabinet cabinet depth is 24" (24<sup>7</sup>/<sub>8</sub>" with door). They are offered in 3 heights, 84", 90" and 96". 24" wide tall storage cabinets (TB) are available with 2 or 4 doors, all wider cabinets have 4 doors. The oven cabinets (TT) start at 27" in width. Stainless pulls, hinges and hardware are included.

TBXXXX — Tall Storage Cabinets - 24" deep

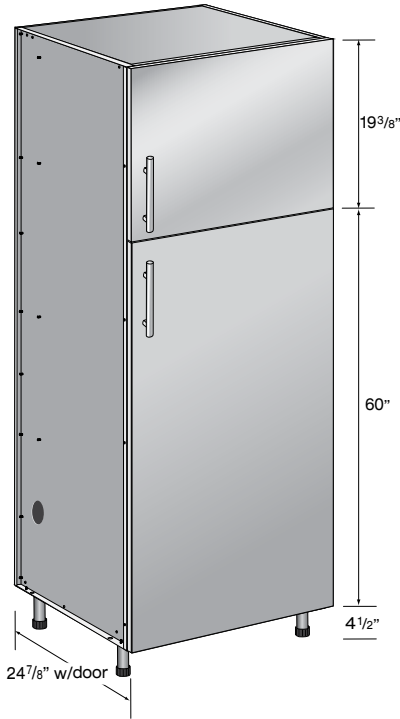

Example: Tall Storage Cabinet part number nomenclature;  
TB2484-4: 24" Wide Tall Base Cabinet  
TB      24      84      4  
Tall Base   Width   Height   Doors

Cabinets 18" to 21" wide have 2 doors, one upper and one lower, specify right or left hinge. 24" cabinets are available with 2 and 4 doors. Cabinets 27" and over have 4 doors.

Cabinets come standard with 4<sup>1</sup>/<sub>2</sub>" adjustable legs. A square shaped tapered stainless steel leg with adjustable foot is also available for an open contemporary look. Black anodized or stainless toe kick may be ordered separately and cut on-site. Stainless pulls, hinges and screws are included.

Optional pull out and stationary shelves are available.

ITEM #	ITEM #
TB1884	TB2784
TB1890	TB2790
TB1896	TB2796
TB2184	TB3084
TB2190	TB3090
TB2196	TB3096
TB2484	TB3384
TB2484-4	TB3390
TB2490	TB3396
TB2490-4	TB3684
TB2496	TB3690
TB2496-4	TB3696

TTXXXX — Tall Oven Cabinets - 24" deep - 1 Drawer, 2 doors

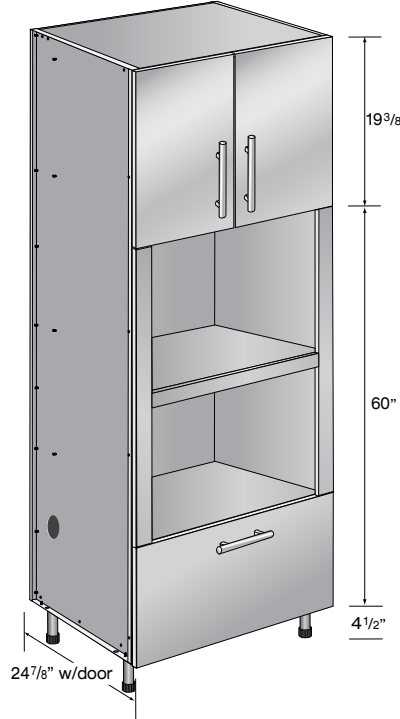

Example: Tall Oven Cabinet part number nomenclature;  
TT3390: 33" Wide Oven Base Cabinet  
TT      33      90  
Tall Base   Width   Height

Cabinets come standard with 4<sup>1</sup>/<sub>2</sub>" adjustable legs. A square shaped tapered stainless steel leg with adjustable foot is also available for an open contemporary look. Black anodized or stainless toe kick may be ordered separately and cut on-site. Stainless pulls, hinges and screws are included.

Drawers display premium features including double-wall construction, full extension, under-mount glides and "soft-close, self close". Doors have a PVC core to add "heft" and weight to provide a solid close and feel.

Optional pull out and stationary shelves are available.

ITEM #
TT2784
TT2790
TT2796
TT3084
TT3090
TT3096
TT3384
TT3390
TT3396
TT3684
TT3690
TT3696



## OTPXX – TRASH PULLOUT ACCESSORY



Shown installed in an OBD1811 cabinet. Trash pullouts are designed to fit 15"- 24" wide OBF, OBD, OBB Side Burner cabinets, and 36", 42" and 48" Grill cabinets.

## OSHXXP – Pullout Shelf

Stationary and pullout shelving is available. Pullout shelves may be placed at various heights and installed in base cabinets with a door. For ice chests, shelves come with extra heavy duty glides and hold up to 175lbs.

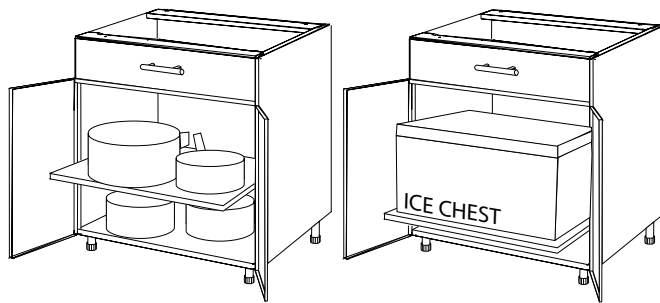

## FILLERS & PANELS

**Fillers:** May be used to fill space between cabinets and/or between a wall and cabinet. Designations: OFLF and size (front filler), OFL and size (back filler).

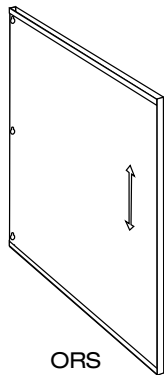

ORS

**Spacers:** Used to "lock-in" the exact size opening for under counter appliances. Spacer attaches behind refrigerators, ice makers or dish washers to cabinets on either side of the opening. Designation: ORS and size.

**Corner Fillers:** 45° and 90° angles used to attach cabinetry together for continuous look. Standard corner fillers are 4" on either side on bend. Designation: OAF and degree bend (front filler) and ORF and degree bend (rear filler).

**Finished Ends, Side and Rear Panels:** Due to the fabrication method, exposed sides and rear of the cabinetry require finished panels. Designation: OSP and depth (side panels), OBP and width (rear panels) and OBPV and width (vented rear appliance panels).

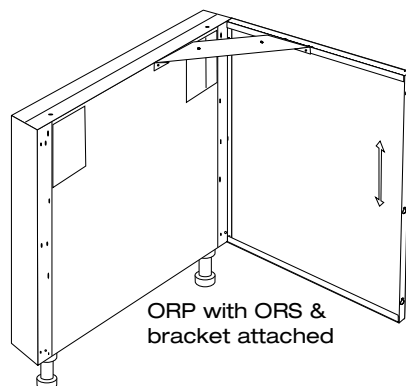

ORP with ORS & bracket attached

**Refrigerator Side Panels:** To support the countertop where appliance is positioned at the end of a cabinet run. The side panel is 37/8"W and attaches to a spacer (ORS). It is finished on one side and adjustable legs are included. Designation: ORP and appropriate depth.

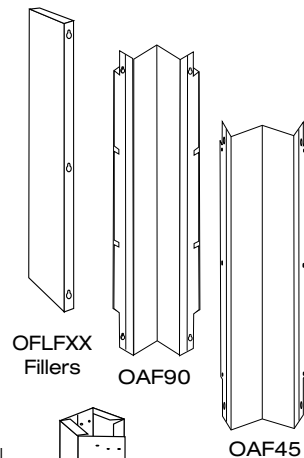

OFLFX Fillers

OAF90

OAF45

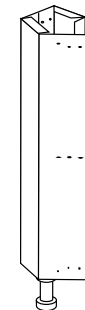

OAR45 (includes panels)

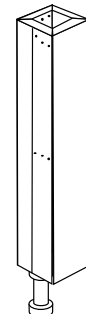

OAR90 (includes panels)

**Cabinet Trim:** A flat 30"H x 4"D finished stainless piece that attaches to a cabinet to hide the unfinished wall located next to an under counter appliance. Designation: OCT4 (adds only thickness of metal to width).

**Box Columns:** Attaches to a corner filler to support the countertop where an appliance is adjacent to the corner. Also attaches to spacers to separate two appliances that are positioned together. Box Columns are 3<sup>7</sup>/<sub>8</sub>"W and come with adjustable legs. Designation: OBX and appropriate depth.

**Shelves:** Stationary and pullout shelves are optional features. Pullout shelves have a 2" lip on all four sides. A shelf with "heavy-duty" under mount glides may be specified for ice chests. Designations: OSH and width (stationary shelves), OSH cabinet width and P (pullout shelves) and OSH cabinet width PCHEST (heavy duty pull outs).

**Toe Kick:** Black and Stainless toe-kick are available in 4" and 6" heights. Priced either in 96" lengths or by linear inch, all necessary hardware and clips are included.

**Low Maintenance Finishes:** Powder coat finishes in clear "Protect-A-Coat", several "Species of Wood" and designer colors are available. Finishes are resistant to salt air, chlorine and muriatic acid.

**Door Style Upgrades:** Standard Hampton slab door may be ordered as a Rio (open for glass) for use as wall cabinet door. Key West (shaker style) and South Beach (mitered) doors accept stainless, powder coat designer colors or wood grain finished panels as well as glass. The South Beach door style is for indoor use only.

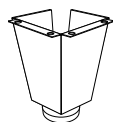

SS LEG

If toe kicks are not used we offer a finished stainless steel adjustable leg to complete the cabinet run.

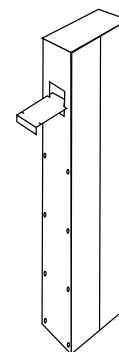

OCP41

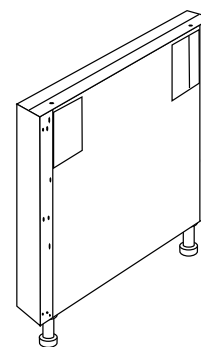

BX 28-5/8

## BARBECUE GRILL HOODS – Extra Depth for Grills & Appliances

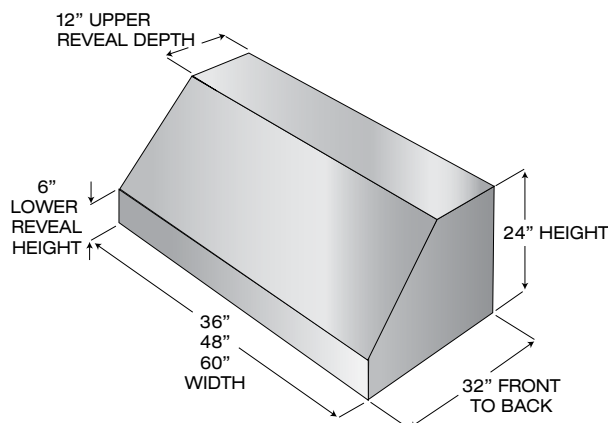

ITEM #	BRIEF DESCRIPTION
DOHC36	36" 1300 CFM Outdoor Hood, 36"W x 32"D x 24"H, Halogen lights, 3 speed, includes blower
DOHC48	48" 1300 CFM Outdoor Hood, 48"W x 32"D x 24"H, Halogen lights, 3 speed, includes blower
DOHC60	60" 1300 CFM Outdoor Hood, 60"W x 32"D x 24"H, Halogen lights, 3 speed, includes blower
Inline Blower	1266 CFM inline blower to replace internal blowers
Duct Silencer	36" duct silencer for 10" duct work (for inline blower only)

Generously proportioned 32" depth of hood provides an exceptional capture area for BBQ grilling. Hoods feature two internal sealed motors that deliver 1200 CFM, Four — 12" by 15" baffle filters improve performance (six filters on 48", eight filters on 60"), Optional in-line

blowers deliver 1266 CFM (10" diameter ducting) (purchased separately). Available in 3 sizes 36"W, 48"W, and 60"W. Blower Assembly can be purchased separately to be built into custom enclosures. ex. DOHC48-Liner. Duct covers are available (specify).

Wall cabinetry is available in 3" increments from 12" to 36" wide. Standard heights also start at 15" and go to 42". The outside dimension is 13" (13<sup>7</sup>/<sub>8</sub>" including door). Two doors are furnished with cabinets 24" to 36" in width. The line includes diagonal corner and blind corner wall cabinets. Every cabinet is supplied with a top and bottom finished panel, stainless pulls and European style stainless hinges & hardware. Finished side panels are optional and are available in two configurations: flush to the cabinet side and as a 3/4" thick panel flush to the face of the door. Doors may be ordered in different styles and open for glass (OFG). For "low maintenance" requirements, they can be painted in clear (Protect-A-Coat), or powder coat specified colors. Powder coat versions of several wood species are also available. Wall cabinetry may also be fitted with standard or stainless legs and used as shallow depth base cabinets. 1 - 3 shelves are included, depending on the height of the cabinets.

Example: Wall Cabinet part number nomenclature;

WS3642: 36" Wide, 42" High Wall Cabinet

WS      36      42  
Wall Cabinet   Width   Height

WSXXXX – Wall Cabinets

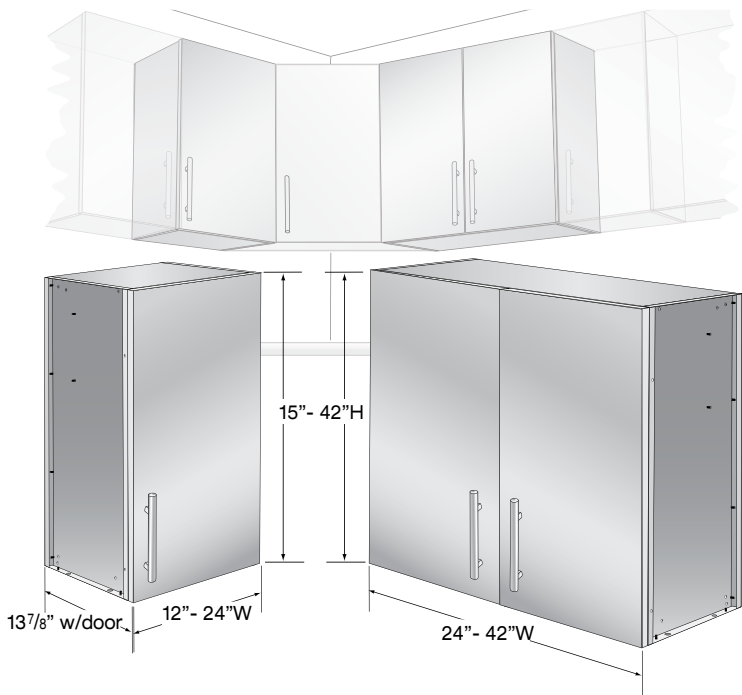

On all single door cabinets specify right or left hinge.

Wall corner units are available as well to fit directly over the coordinating bases.

We also offer refrigerator depth (24") cabinets in a variety of widths and in 12" and 15" heights.

Finished end panels, both flush and 3/4" thick are available.

ITEM #
WS1536
WS1836
WS2136
WS2436
WS2736
WS3036
WS3336
WS3636
WS4236
MICROWAVE CABINET
MWC2736
DIAGONAL CORNER WALL
DCW36
BLIND CORNER WALL
WB3036

Example of cabinet item#s above for 36" high cabinets.

Additional cabinet heights available: 15", 18", 21", 24", 30", 42".

Designers and builders of masonry island kitchens are now offered a complete line of door, drawer/drawer combinations and pullout cabinetry to construct a totally functional kitchen. The line features the optional Clean-Stor® box that attaches to door fronts to create useful storage and organization. The Clean-Stor® box eliminates the infamous "masonry black hole" that lurks behind access doors. The steel construction is superior to presently used insert materials that are subject to warping, rotting and mildew. The Clean-Stor® box comes with a shelf and provides clean dry storage.

Doors exhibit the same stainless quality, "heft & weight" and solid close as the modular cabinetry line allowing additional design flexibility by using both lines to create the ideal kitchen while retaining a consistent "look".

The insert line includes:

- One and Two Drawer Units
- Door and Drawer Combination Units
- One and Two Door (and frame) Units
- Paper Towel Dispenser
- Trash and Propane Pullouts

Access Door Inserts may be purchased with just the frame and doors or combined with the "Clean-Stor®" box as a complete unit.

### IDR -ACCESS DOORS

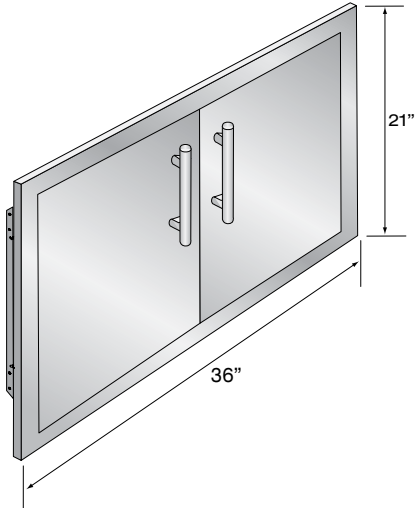
	ITEM #	DESCRIPTION	CUT OUT SIZE
	IDR1725-1	17"W x 25"H Frame, One Flush Access Door	14 <sup>5</sup> / <sub>8</sub> "W x 23 <sup>1</sup> / <sub>2</sub> "H
	IDR1621-1	16"W x 21"H Frame, One Flush Access Door	13 <sup>5</sup> / <sub>8</sub> "W x 19 <sup>1</sup> / <sub>2</sub> "H
	IDR2121-1	21"W x 21"H Frame, One Flush Access Door	18 <sup>5</sup> / <sub>8</sub> "W x 19 <sup>1</sup> / <sub>2</sub> "H
	IDR2721-2	27"W x 21"H Frame, Two Flush Access Doors	24 <sup>5</sup> / <sub>8</sub> "W x 19 <sup>1</sup> / <sub>2</sub> "H
	IDR3021-2	30"W x 21"H Frame, Two Flush Access Doors	27 <sup>5</sup> / <sub>8</sub> "W x 19 <sup>1</sup> / <sub>2</sub> "H
	IDR3025-2	30"W x 25"H Frame, Two Flush Access Doors	27 <sup>5</sup> / <sub>8</sub> "W x 23 <sup>1</sup> / <sub>2</sub> "H
	IDR3621-2	36"W x 21"H Frame, Two Flush Access Doors	33 <sup>5</sup> / <sub>8</sub> "W x 19 <sup>1</sup> / <sub>2</sub> "H
	IDR4221-2	42"W x 21"H Frame, Two Flush Access Doors	39 <sup>5</sup> / <sub>8</sub> "W x 19 <sup>1</sup> / <sub>2</sub> "H

### CLEAN-STOR® BOX WITH SHELF

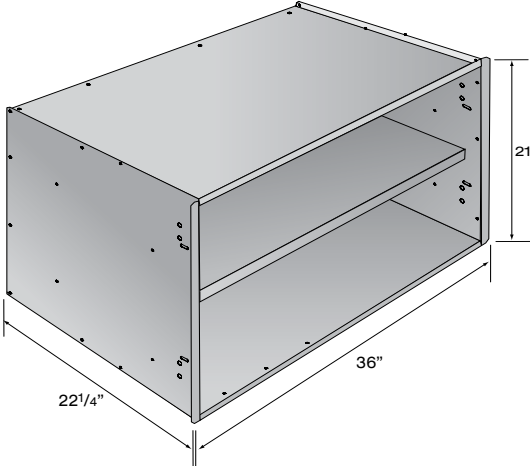
	ITEM #	DESCRIPTION
	IDR1725-B	Clean-Stor® storage box for IDR1725
	IDR1621-B	Clean-Stor® storage box for IDR1621
	IDR2121-B	Clean-Stor® storage box for IDR2121
	IDR2721-B	Clean-Stor® storage box for IDR2721
	IDR3021-B	Clean-Stor® storage box for IDR3021
	IDR3025-B	Clean-Stor® storage box for IDR3025
	IDR3621-B	Clean-Stor® storage box for IDR3621
	IDR4221-B	Clean-Stor® storage box for IDR4221

Galvanized Storage Box to install behind frame (order at the same time as Access Doors), all Clean-Stor® boxes are 22<sup>1</sup>/<sub>4</sub>" Deep

## IDW – DRAWER SETS (includes Clean-Stor® Box)

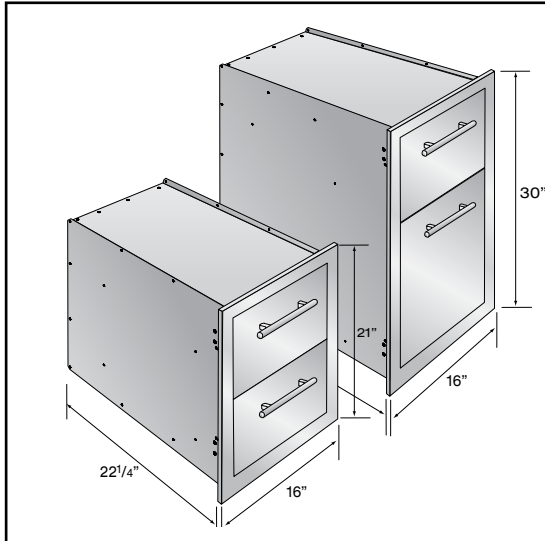

ITEM #	DESCRIPTION	CUT OUT SIZE
IDR1621-2	16"W x 21"H Frame, 2 drawers w/box	13 <sup>5</sup> / <sub>8</sub> "W x 19 <sup>1</sup> / <sub>2</sub> "H
IDR1630-2	16"W x 30"H Frame, 2 drawers w/box	13 <sup>5</sup> / <sub>8</sub> "W x 28 <sup>1</sup> / <sub>2</sub> "H

## IC – DOOR DRAWER SETS (includes Clean-Stor® Box)

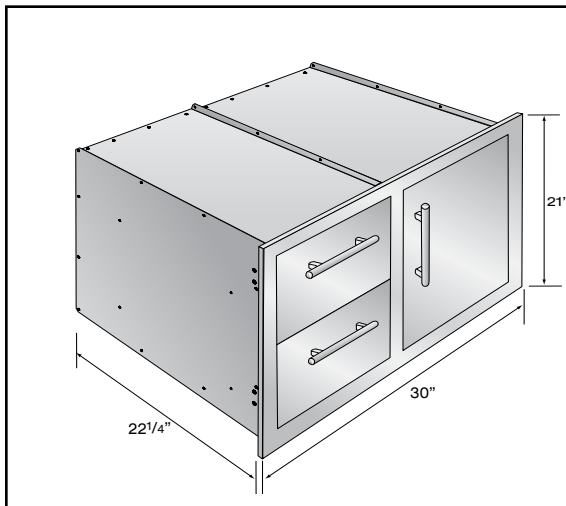

ITEM #	DESCRIPTION	CUT OUT SIZE
IC3021-21	30"W x 21"H Frame, 2 drawers, 1 door, 2 separate boxes. Specify drawers on left or right of door.	27 <sup>5</sup> / <sub>8</sub> "W x 19 <sup>1</sup> / <sub>2</sub> "H

## TRASH &amp; SPECIALTY INSERT CABINETS

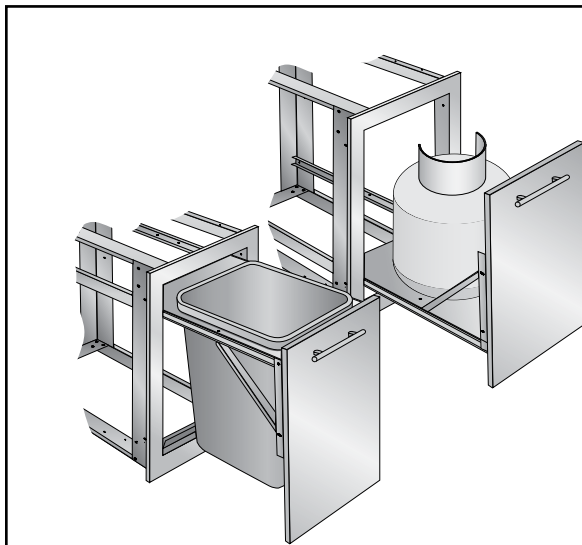

ITEM #	DESCRIPTION	CUT OUT SIZE
ITR1725	IDR1725 Frame with Trash Pull Out	14 <sup>5</sup> / <sub>8</sub> "W x 23 <sup>1</sup> / <sub>2</sub> "H
IPR1725	IDR1725 Frame with Propane Pull Out	14 <sup>5</sup> / <sub>8</sub> "W x 23 <sup>1</sup> / <sub>2</sub> "H
IPT1711	17"W x 11"H Paper Towel Dispenser	15 <sup>1</sup> / <sub>2</sub> "W x 8 <sup>5</sup> / <sub>8</sub> "H

