

BROWN JORDAN®
OUTDOOR
KITCHENS™

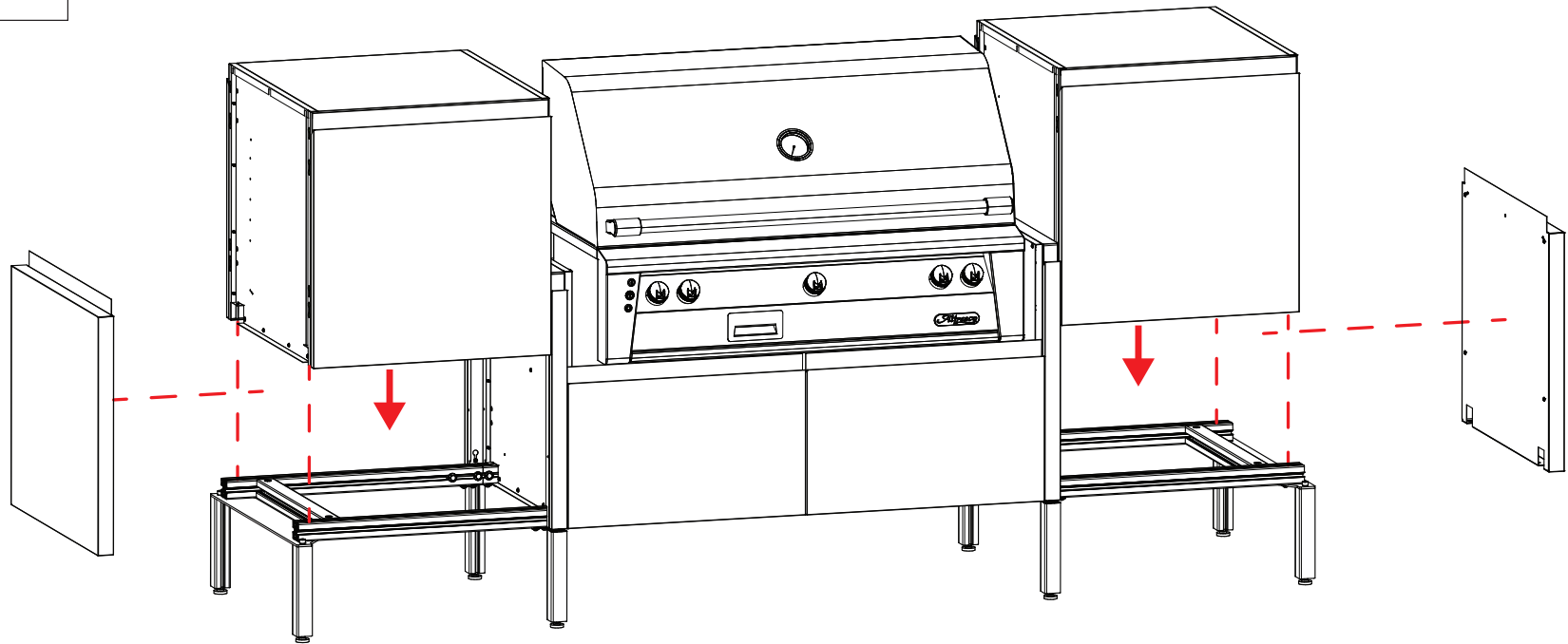

Installation Guide: Elements™

IMPORTANT: READ FIRST



This guide contains basic information required to install Brown Jordan Outdoor Kitchens cabinetry. The specifics of the design, configuration, location, space and other factors influencing your project, may require deviations from the stated instructions.

It is recommended that installation be performed by a licensed contractor or other professional with experience installing cabinetry.

Observe Local Building Codes

Local building codes may supersede the information contained within this guide. It is imperative that you understand and adhere to local codes and regulations prior to installing the cabinetry and appliances.

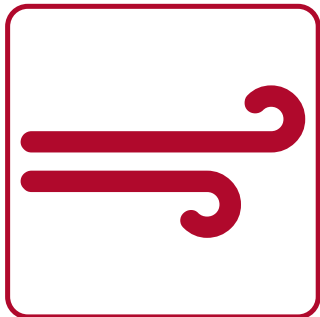

High Wind Areas

If you are installing the cabinetry in a high-wind area, such as a rooftop or in a geographic region that is susceptible to tornados or hurricanes, you are likely required by building code to secure the cabinetry to an immovable structure such as a wall, floor or concrete base.

INSTALLATION SITE PREP

Prepare area for the kitchen:

Make sure that your installation site is as level as possible and that there will be minimal additional landscaping to be performed after the cabinets are installed.

When starting the installation, check floor for pitch both side-to-side and front-to-back to find the highest point. Your choice of under-counter appliances may impact and determine the finished height of the cabinetry.

Level line across back wall (if applicable). If there is a corner, start in the corner and adjust cabinets to this line.

Utility access holes:

All cabinets come standard with utility access holes for services (electrical, plumbing, gas). It is encouraged that all services align with these existing access holes. In the event a new hole does need to be made, using a metal nibbler or knockout tool is the recommended method. A metal bit hole saw may also be used to drill through cabinets.

GFI electrical outlets should be placed in the cabinet adjacent to the appliances to allow for ease of resetting the GFI and to ensure proper fit of the appliance.

Notes on unpacking cabinets:

- Carefully review the packing list to verify your order has been shipped complete. Unpack cabinets and parts, making sure not to scratch the product, misplace any hardware or accessories.
- Doors and drawers are shipped installed with standard stainless steel pulls.
- It is recommended that all doors, drawers and shelves be removed during the placement and installation process.
- Uninstall shipping brackets from appliance cabinets BEFORE ATTACHING ADDITIONAL CABINETS and reinstall in proper position near the back of those cabinets where they act as counter top supports. See page 9 for full details.

INSTALLATION TIPS AND SITE PREP

Basic Notes on Installation:

Required Tools:			
Power screw driver with #2 Phillips head bit	#2 Phillips head manual screw driver	Level (4ft. long minimum)	Tape measure
6mm Allen wrench (supplied)	5/16 Allen wrench (supplied)	Adjustable wrench	

- For proper installation of outdoor kitchen cabinetry, it is essential to make sure each cabinet is level and plumb. Failure to do so will result in a myriad of problems, such as poor cabinet door adjustment and/or installation of countertops, etc.

- Obtain proper level for every cabinet using a minimum 4 ft. long level. A 6 ft. or 8 ft. level is preferred.
- Level from corner to corner, left to right and front to back on each cabinet as you install.
- Ensure that each cabinet is also vertically plumb to prevent tilt/leaning.
- Always begin at the highest point of the installation site and establish a level line above the floor from that point.

- DO NOT completely remove vinyl protective coating until installation is complete. Peel back vinyl only in areas where it will be hard to remove after installation (e.g. back and side panels, fillers).

NOTE: The vinyl protective coating is for temporary protection during transport and installation. Prolonged exposure to light and heat may cause degradation, which can stain or damage the cabinets. Cabinets should be warehoused in a cool, dry location or remove the vinyl protective coating for extended storage.

- Remove all drawers, shelving and doors before installation. This will make cabinets easier to lift, install and gives access to installation areas. See page 6 for full drawer removal details.
- Install cabinets in final position. The cabinets are difficult to move after assembly is complete.
- Install the first cabinet at the highest point, then install adjacent cabinets.
- Cabinets may flex until they are locked into place with one another. If necessary, adjust and tighten screws on the cabinet top rails prior to installation.
- Install cabinets completely (screwed together, counter top installed, appliances installed, doors installed, drawers returned to original positions and level is obtained) before adjusting doors or drawers. See pages 14-15 for proper adjustment details.

Installation Resources:

For additional resources, such as installation videos, PDF instructions and cleaning guides, visit: brownjordanoutdoorkitchens.com/resources

ASSEMBLY & INSTALLATION: Frame Assembly

Compare and verify product number(s) on box(es) to the order and packing list. Carefully unpack cabinets.

1. Remove and check hardware bag/box that contains legs, screws for assembly and attaching cabinets to one another, extra bumpers, for access holes.

2. Remove foam packing material and discard.

3. The Frame Assembly will arrive assembled and to the length of the project specifications.

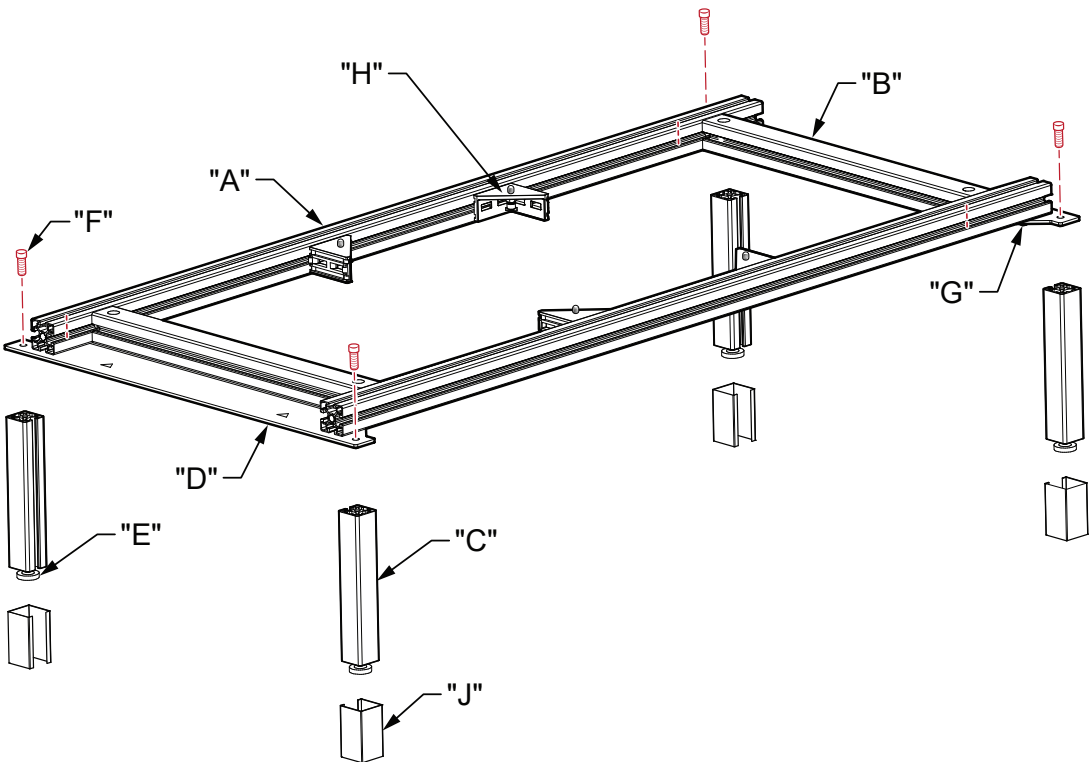

LABEL	QTY	DESCRIPTION
A	2	BOTTOM FRAME LENGTH (45MM) LENGTH CUT PER ORDER
B	2	U130-1 CROSSMEMBER (45MM)
C	4	U123-1 LEG (SINGLE SLOT FACES INWARD)
D	2	246 ADAPTER PLATE
E	4	U124 GLIDES
F	4	N157 SOCKET HEAD CAP SCREW
G	8	N203 T-STUD W/NUT
H	A/R	J193 JACK SCREW ASSEMBLY
J	4	276 LEG COVER

INSTALLATION: Frame Leg Assembly

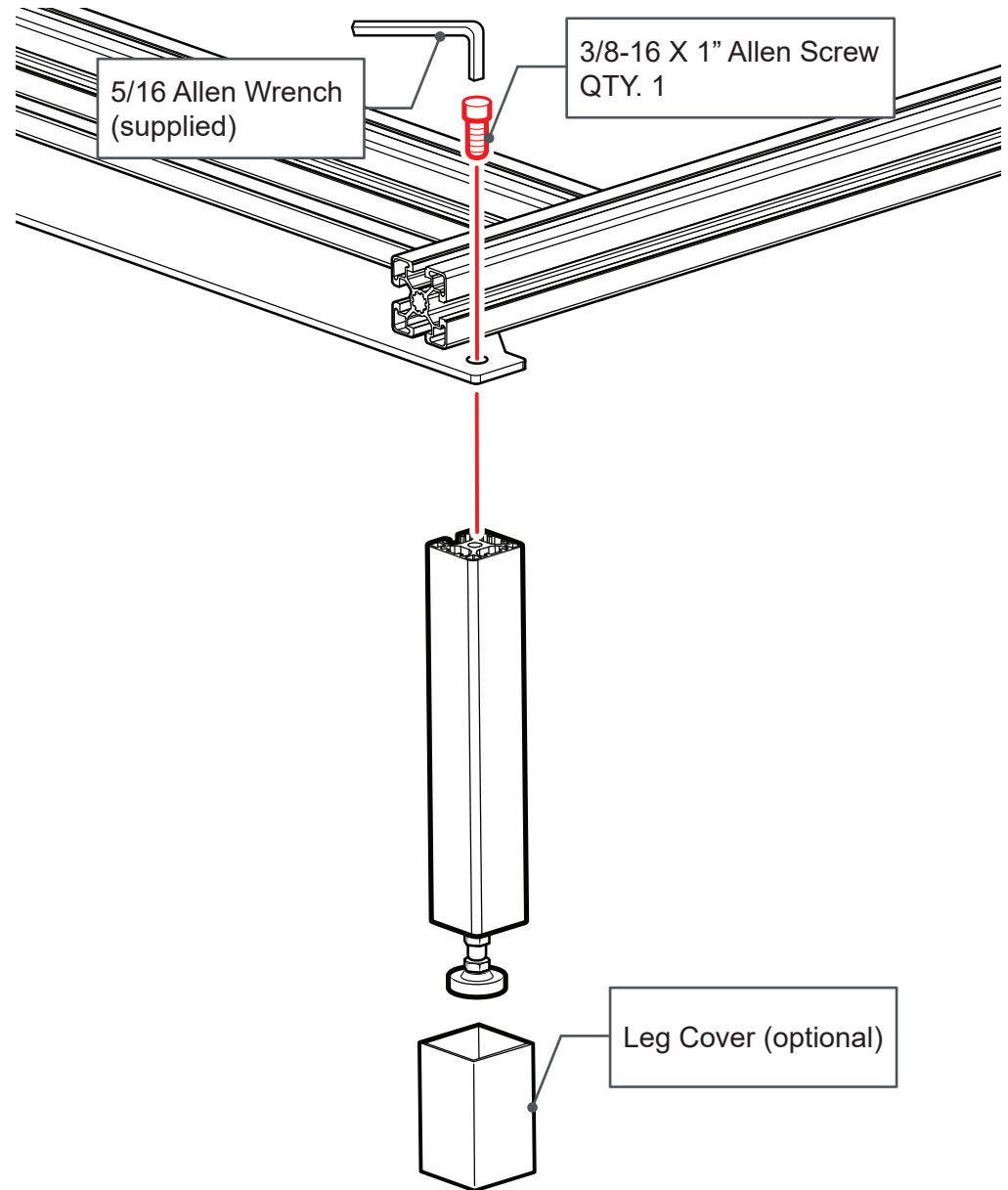

1. Using the supplied 5/16 Allen wrench, attach each leg to the frame with (1) 3/8-16 x 1" Allen Screw per leg. Ensure the slot is facing inward and Tighten.
2. Install the optional leg cover over each leg (Supplied)

INSTALLATION: Frame Leg Glide Adjustment

1. Using the installed Glide on each leg, ensure the Frame Assembly is Level, Plumb and Square.
2. Adjust the Glide by unscrewing the post.
3. Once adjusted to the desired level, tighten the locknut to secure in place.

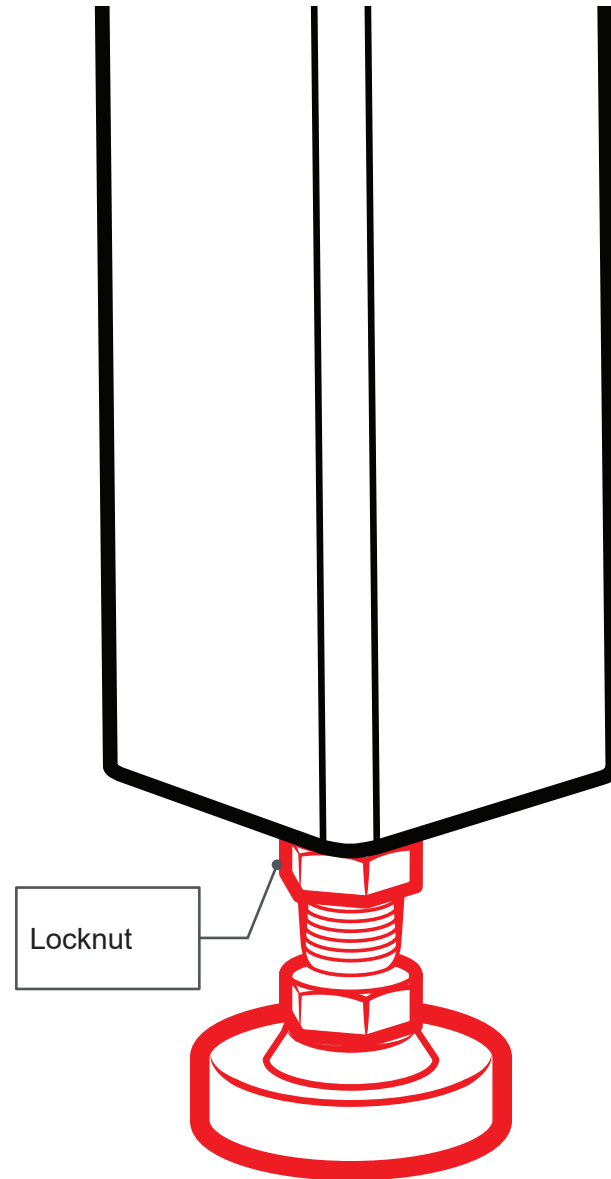

ASSEMBLY & INSTALLATION: Drawer Removal

Removal of cabinet drawers allows for ease of moving, assembly and installation.

Be sure to store drawers away from the work site to prevent damage.

Note: Pull-out trash and shelving parts operate in similar fashion, but the Release Levers are located on the sides.

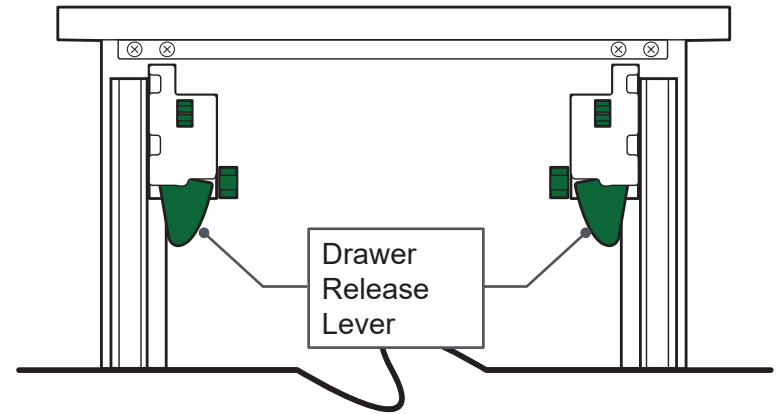

1. Open the drawer fully.
2. Locate the Drawer Release Levers on the underside of the drawer.
3. Depress both Drawer Release levers at the same time and hold.
4. Pull the drawer all the way out of the cabinet.

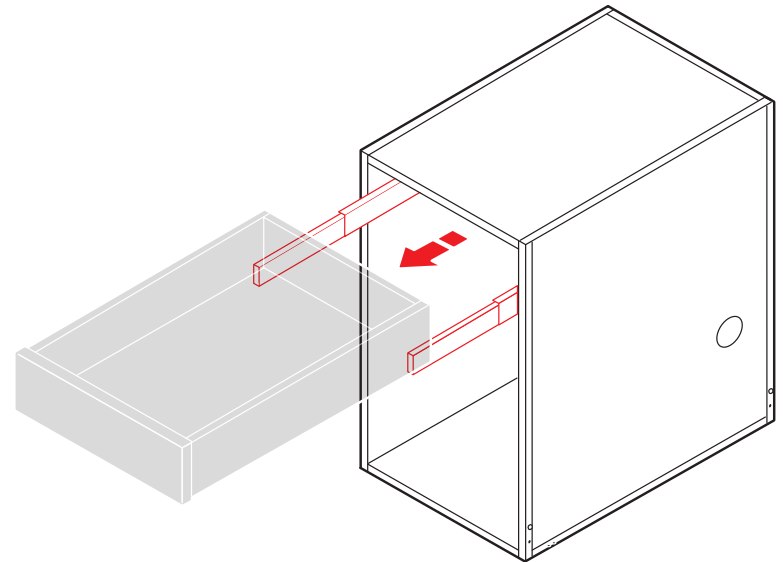

ASSEMBLY & INSTALLATION: Cabinet Installation/Joining Cabinets

Though the Elements by Tecno cabinet is assembled on a frame which is levelled, it is important to ensure each cabinet is level, plumb and square during the installation process.

1. Place the cabinet onto the Frame Assembly. Check for fit.

Note: always start at one end, ensuring each cabinet is level, plumb and square.

2. Line up the end cabinet with the 2 arrows marked on the adapter plate.

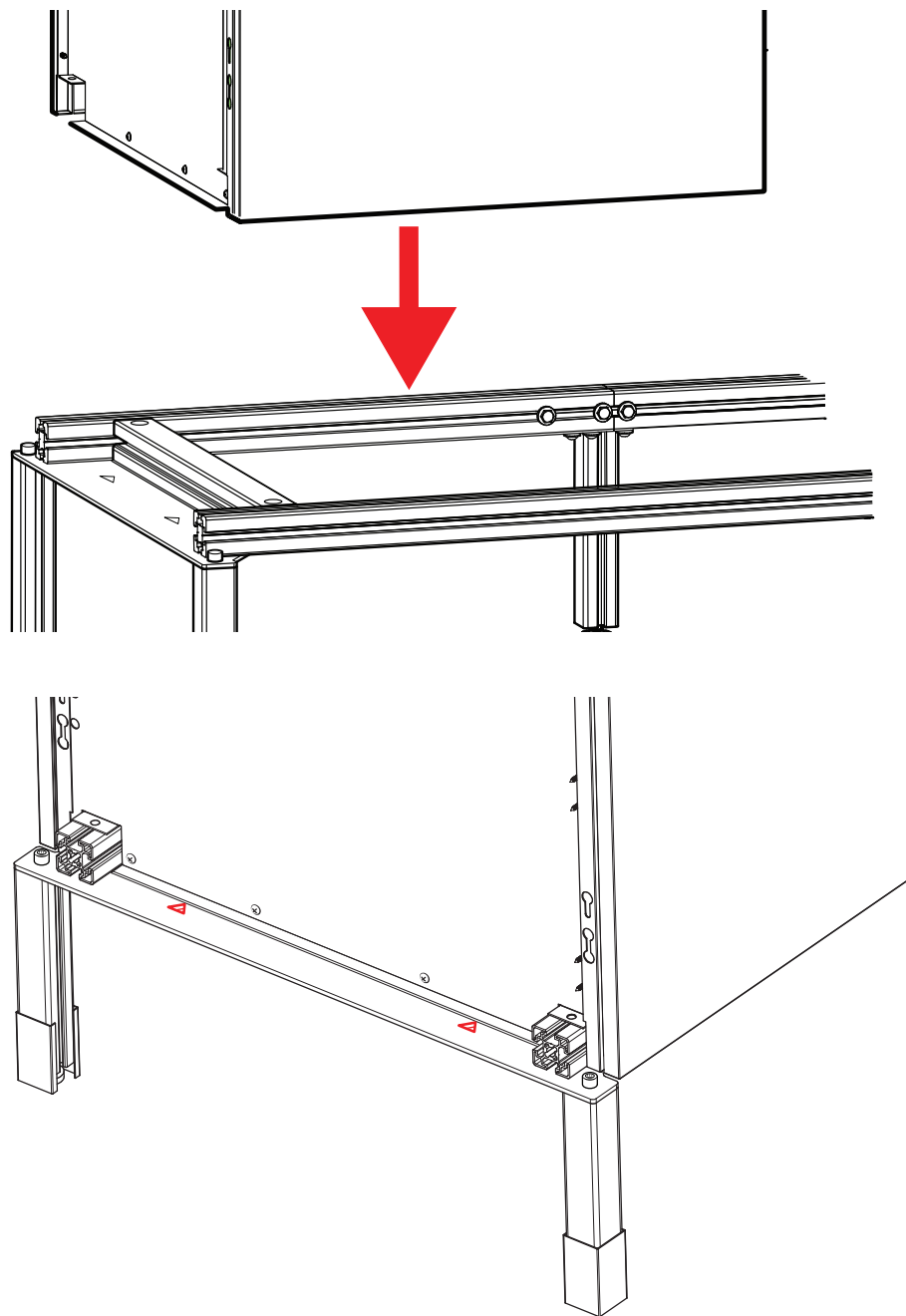

ASSEMBLY & INSTALLATION: Cabinet Installation/Joining Cabinets

1. Secure the end cabinets onto the Frame Assembly, using (2) T-Bolts and T-Nuts. Tighten.

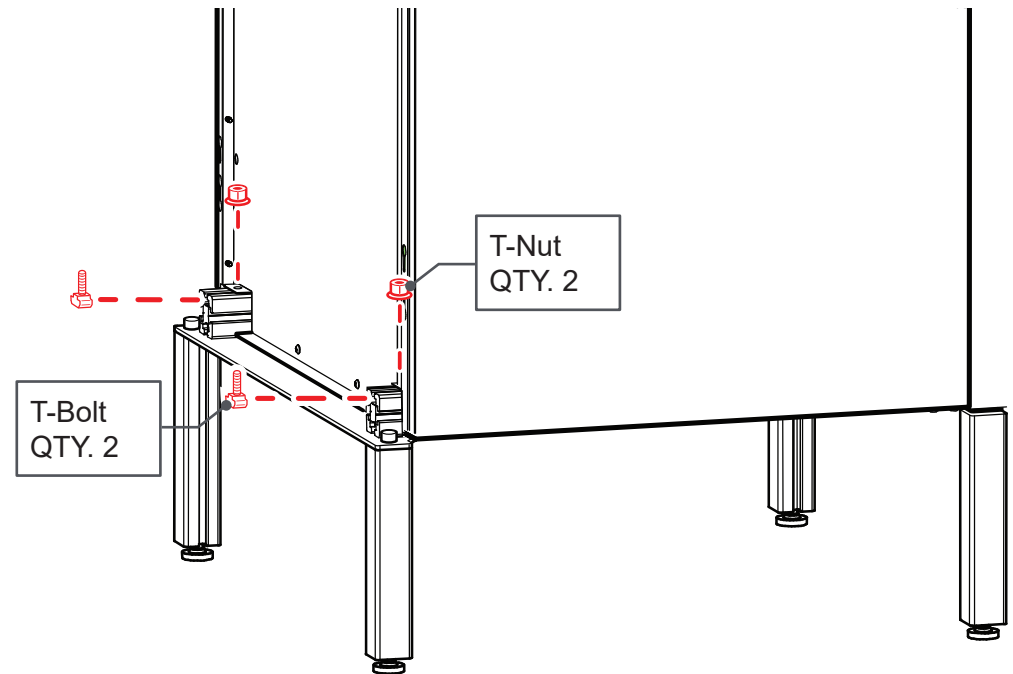

2. Partially install (1) #10 screws in Easy-Alignment holes on right side of cabinet. Do not tighten.

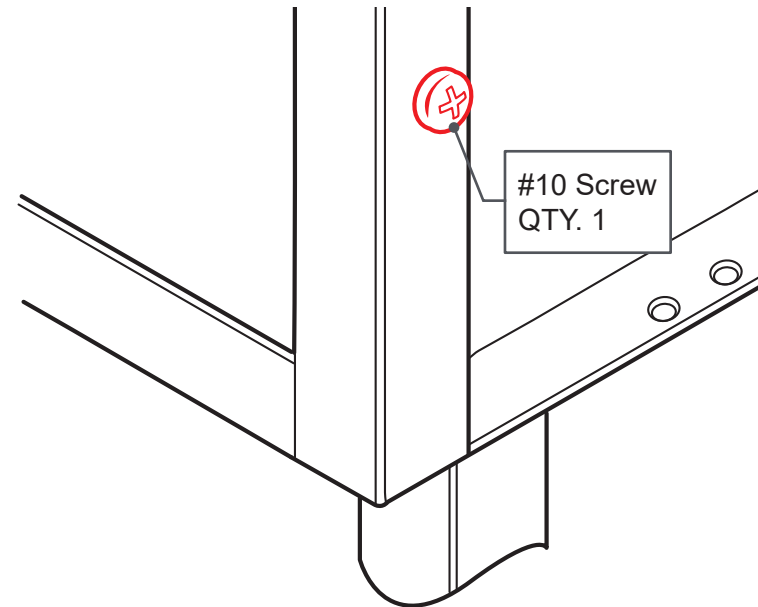

3. Place the next cabinet onto the Frame Assembly.

ASSEMBLY & INSTALLATION: Cabinet Installation/Joining Cabinets

4. Tip & lift either cabinet over screw heads through “Dog Bone” hole.

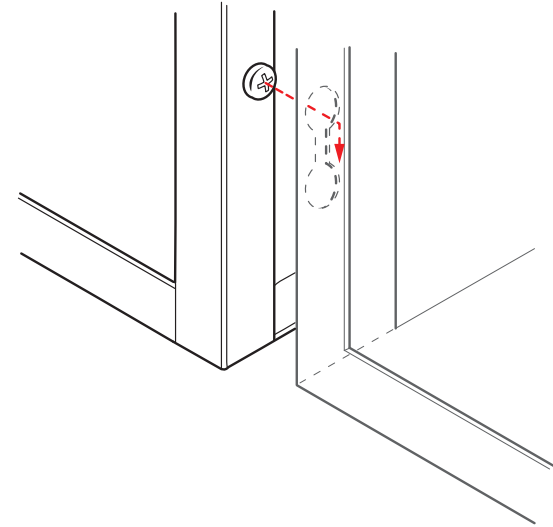

5. Level Cabinets together in all directions so they are plumb, level and square.

6. Tighten the two (2) screws from Step 2 through access holes (Inside Cabinet).

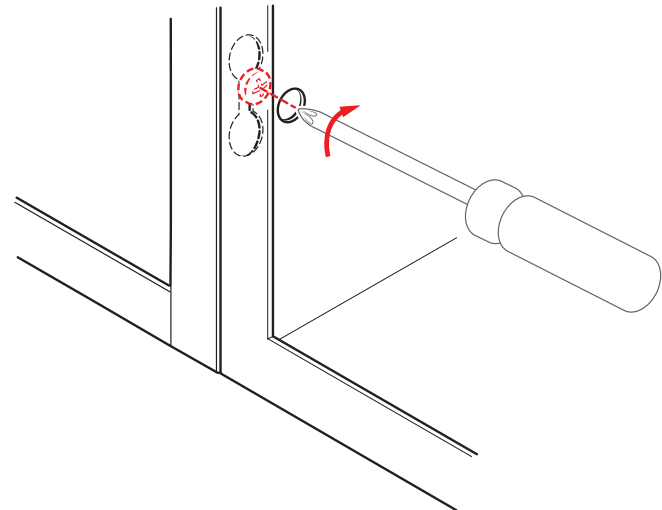

ASSEMBLY & INSTALLATION: Transition Mounting Bracket

The Transition Mounting Bracket is placed between two cabinets.

NOTE: Front fillers are designed to extend to the face of the cabinet door.

1. Partially install (2) #10 screws in Easy-Alignment holes on the side of Spacer. Do not tighten.
2. Insert the #10 screws through the “Dog Bone” of the cabinet .
3. Use clearance holes on side panel inside the cabinet to tighten down spacer front and back, top and bottom on both sides
4. Attach the magnetic Transition front and back panels to cover the Transition Mounting Bracket.

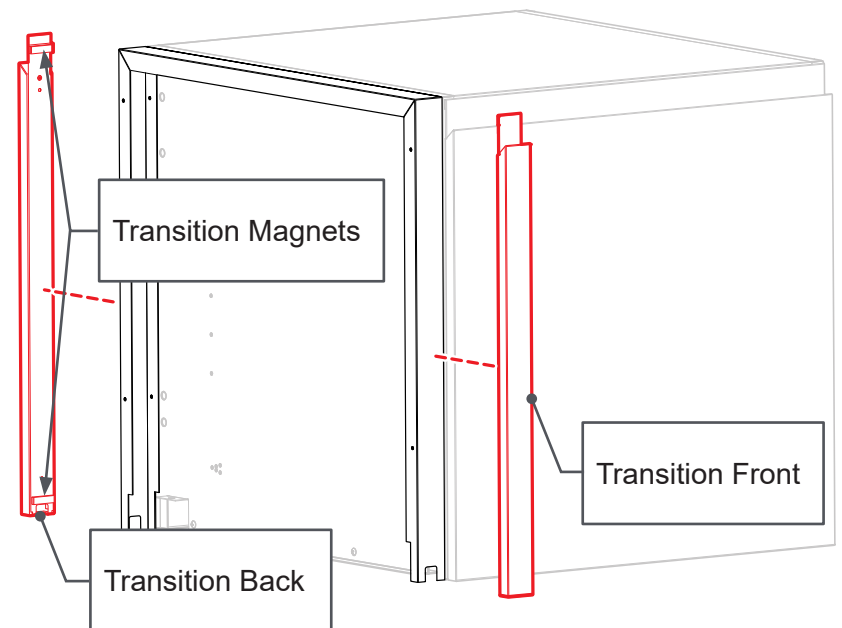
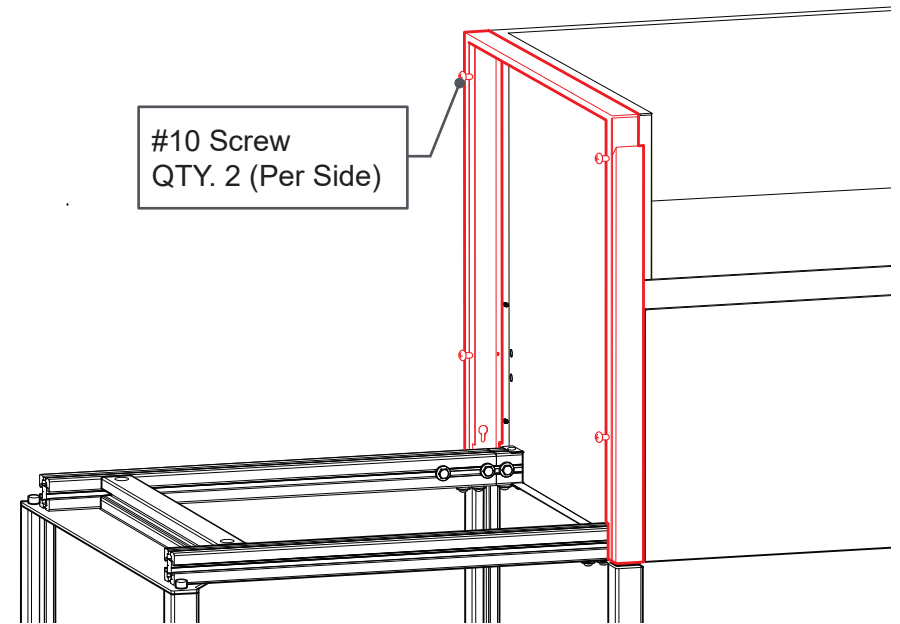

ASSEMBLY & INSTALLATION: Appliance and Grill Cabinet

1. Remove drawers and accessories that may hinder assembly and store in a safe place.
2. Remove the Shipping Bracket from the front of appliance cabinet by removing the #10 screws. The Rear Countertop Support's location is dependent upon the depth (front to back) of the grill/appliance, so it is necessary to know the grill manufacturer's specified depth. Take the manufacturer's depth and add .5" to the measurement. Then measure from the front, including the door or trim, and locate the pre-drilled holes at that location in the cabinet side walls. Using the original #10 screws, attach the bracket so it is flush with the top of the cabinet.

NOTE: For grills that do not hang from countertop: Cabinets designed for appliances that sit on the deck of the cabinets (e.g. Viking, Dacor, etc.) are shipped with spacers to shim the grill to the height of most granite countertops. If the counter is more than 1" thick, additional shimming must be used (not supplied). Grill liners/insulation jackets are not required nor accounted for in the cabinet design.

3. Grill/Appliance cabinets come with two (2) bottom & four (4) rear utility access holes (two bottom rear & two top rear). Gas plumbing is typically run through the utility access holes in the floor of the cabinet and then through the access holes in the SS shelf to the fitting on the grill (either left or right side depending on the manufacturer). The plates on the remaining access holes may be removed for airflow as needed.

NOTE: For the Grill Cabinets sizes 42 and 48 that support Caliber Rockwell grills do not move the Rear Countertop Support.

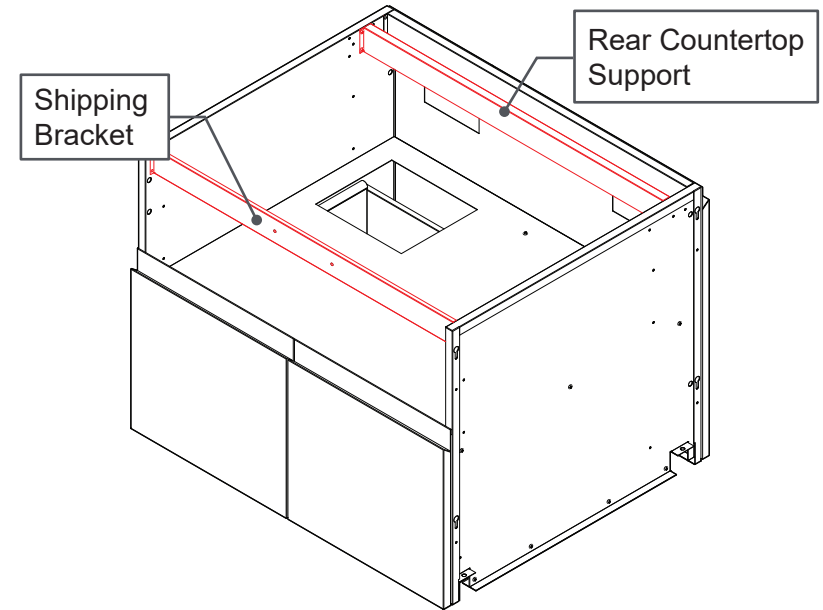

Grill Cabinet, sizes 33, 39 and 45

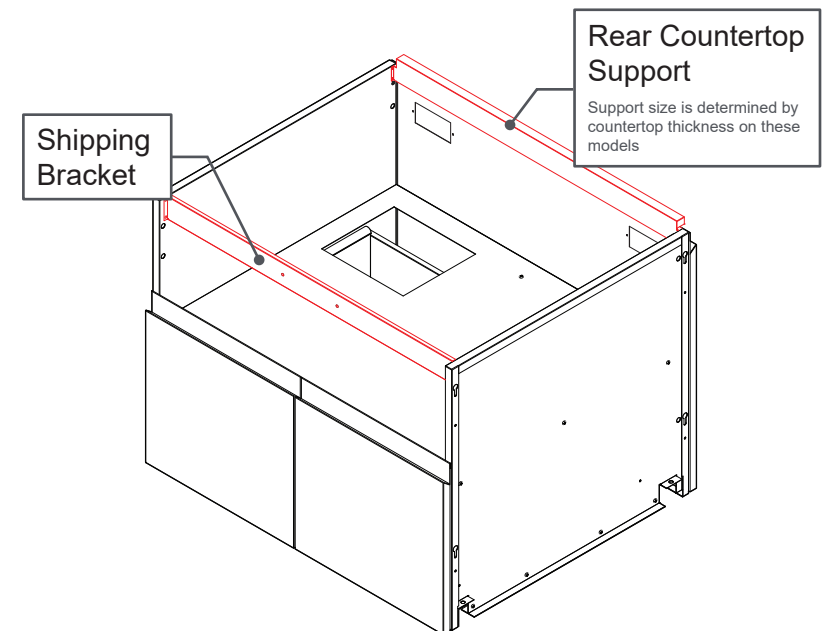

Caliber™ Rockwell Grill Cabinet, sizes 42 and 48

ASSEMBLY & INSTALLATION: OSP LH-RH Panels

1. Attach (4) #10 screws into the Easy-Alignment holes of the End Panel.

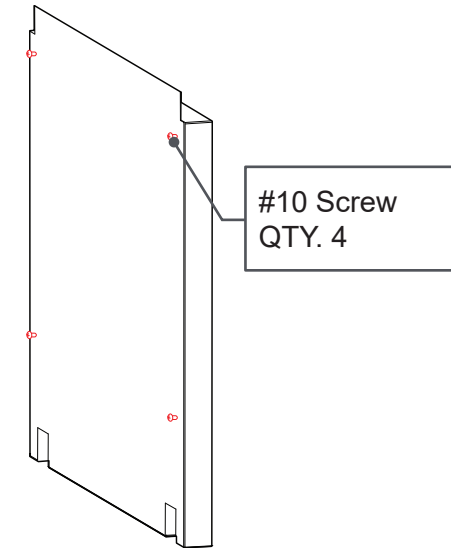

2. Place the #10 screws through the "Dog Bone" on the cabinet.

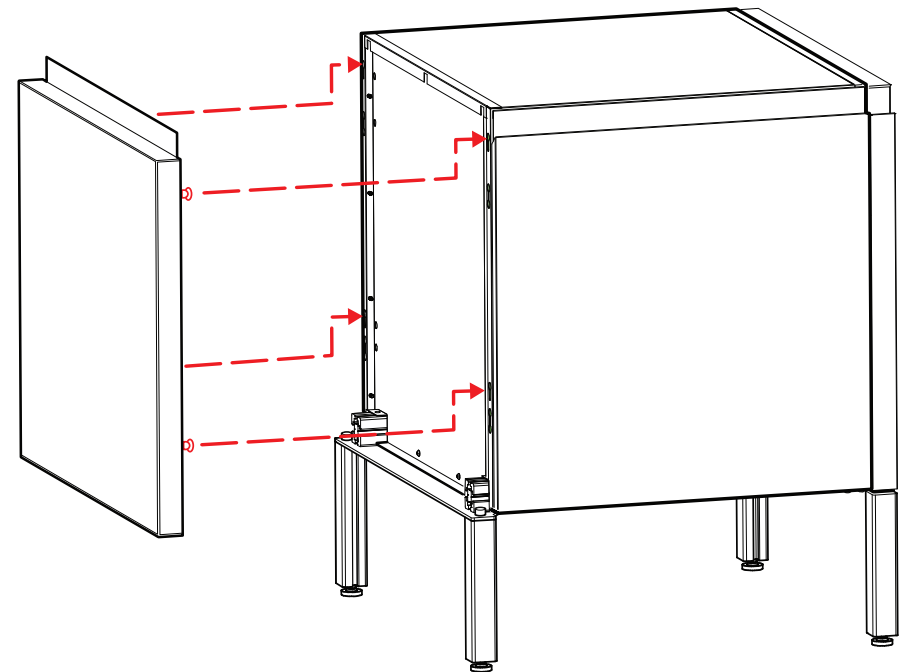

3. Tighten the (4) screws from Step 2 through access holes (Inside Cabinet).

ASSEMBLY & INSTALLATION: Cabinet Door Adjustment

Adjust cabinet doors after all appliances, counter top and other finish work is complete.

1. The front screw is used to center the door in the opening.
2. The rear screw is used to align the front of the door with the cabinet frame and to secure the door to the cabinet. Slightly loosen screw (while holding the door) and slide the door in and out until aligned. Re-tighten.
3. Loosen the hinge plate mounting screws and slide hinges up or down for further adjust, if necessary. Once aligned, re-tighten.

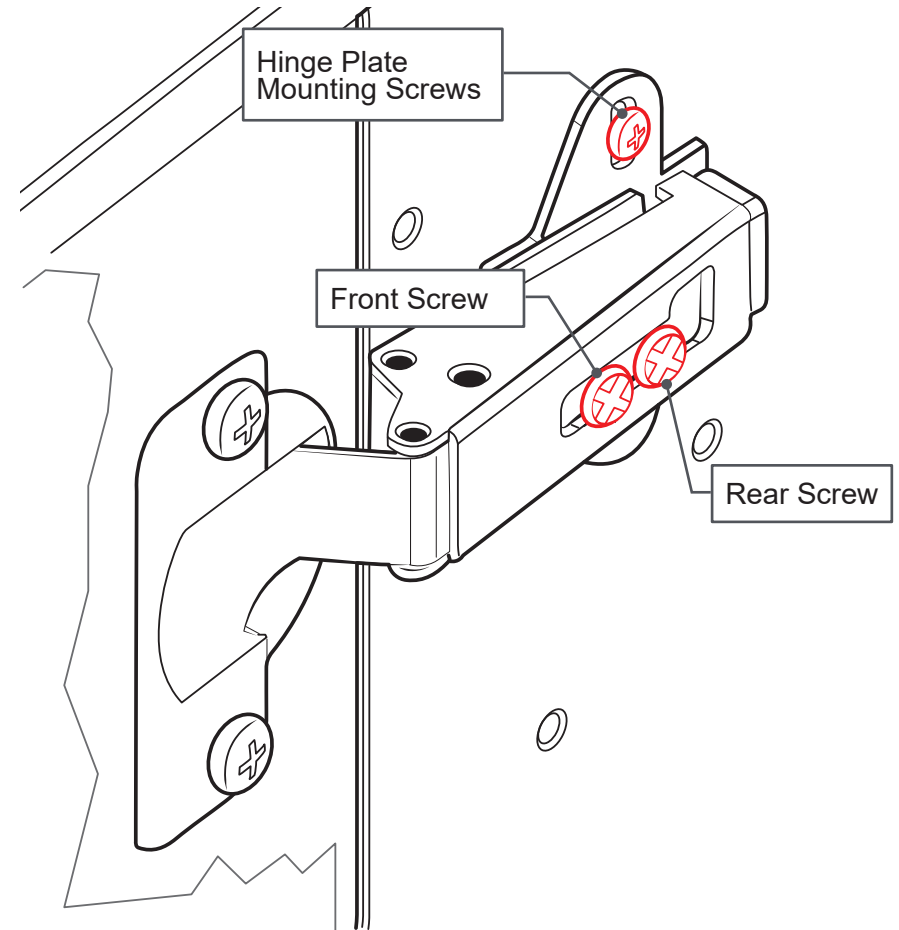

ASSEMBLY & INSTALLATION: Drawer Adjustment

Once cabinets are properly leveled and installed, no drawer adjustment should be required. In the event the drawer does need adjustment, locate the proper adjustment lever(s) on the underside of the drawer.

1. Open the drawer fully.
2. Thumbwheel: adjusts the drawer's position from left to right.
3. Slider: adjusts the drawer's position up and down.
4. Close drawer and check adjustment. Repeat as needed.

